

HISTORICAL STRUCTURE FORM

Site #8 MA-1088

x Original
o Update (give site #)

FLORIDA MASTER SITE FILE

Version 3.0 11/96

Recorder
FieldDate 01/03/99
FormDate 05/31/99

SiteName(s)address if none)Robinson/Long Beach Cottage #4 Multiple Listing [DHR only]

Survey Longboat Key Survey #
National Register Category (Please check one: consult with Site File before using last 4): X building o structure o district o site o object

LOCATION & IDENTIFICATION

Address (Include N,S,E,W; #; St., Ave., etc.) 7140 Longboat Dr E
Cross Streets (nearest /between) Longboat Ct
City / Town (within 3 miles) Town of Longboat Key In Current City Limits: X y o n o unknown
County Manatee Tax Parcel #(s) 77997.0000/5
Subdivision name Longbeach Block 21 Lot 10
Ownership (Please check one): o private-profit X private-individual o city o county o Native American
o private-nonprofit o private-unspecified o state o federal o foreign o unknown
Name of Public Tract (e.g., park)
Route to (especially if no street address)

MAPPING

USGS 7.5' Map Name & Date Bradenton Beach, FL, 1964, PR 1987
Township 35S Range 16E Section 15 1/4 section: o NW o SW X SE o NE o Irregular-name:
Landgrant Thomas Mann UTM: Zone o16 X17 Easting 33464 0 Northing 303549070 0
Plat or other map (map's name, location) Longbeach/Revision of Longboat Beach, 1914 - Manatee Cnty Prop Appraiser

DESCRIPTION

Style\*Frame Vernacular Exterior Plan\* rectangular Number of Stories 1
Structural System(s) \*wood frame
Foundation: Type(s) \* piers Material(s) \* Concrete
Exterior Fabric(s) \*asbestos siding
Roof: Type(s) \* Gable Material(s) \* asphalt shingle
Roof secondary strucs. (dormers etc.) \*
Chimney: No. 1 Material(s) \*brick Location(s) \*N ext
Windows (types, materials, etc.) \*1/1 wood dhs, ind; jalousie, grouped
Main Entrance (stylistic details)
Porches: #open 1 #closed 1 #incised Location(s) E & W
Porch roof type(s) shed
Exterior Ornament metal attic vent - W. gable
Interior Plan\* Unknown
Condition (Please check one): X excellent o good ofair odeteriorated oruinous
Surroundings (N=None, S=Some, M=Most, A=All/nearly all): N commercial A residential S institutional N undeveloped
Ancillary Features Historic 1 car garage on W.
Archaeological Remains None Observed o Check if Archaeological Form completed
\* Consult Guide to Historical Structure Forms for preferred descriptions (coded fields at the Site File).

DHR USE ONLY \$\$\$\$\$\$ OFFICIAL EVALUATIONS \$\$\$\$\$\$ DHR USE ONLY

NR DATE Date / /
KEEPER-NR ELIGIBILITY oyes ono
SHPO-NR ELIGIBILITY: oyes ono opotentially elig. oinsufficient Info Date
DELIST DATE LOCAL DESIGNATION: Date / /
Local office

National Register Criteria for Evaluation oa ob oc od (See National Register Bulletin 15, p. 2)

HISTORY

Construction date: Exactly \_\_\_\_\_(year) Approximately 1933 (year) Earlier than \_\_\_\_\_(year) Later than \_\_\_\_\_(year)

Architect (last name first): Unknown Builder (last name first): Local Carpenters

Moves:  yes  no  unknown . . . . . Dates Original address

Alterations:  yes  no  unknown Dates c.1994 Nature\* W. porch enlargement; E. porch enclosure

Additions:  yes  no  unknown Dates Nature\*

Original Use\* (give date ranges) RESI . . . . .

Intermediate Uses\* (give date ranges) RESI . . . . .

Present Use\* (give date ranges) RESI . . . . .

Ownership History (especially original owner, dates, profession, etc.) . . . . .

**Robinson (c1933-1948); Garman (1948-1960s)** . . . . .

**The Pink House Co (1998-present)** . . . . .

\* Consult Guide to Historical Structure Forms for preferred descriptions (coded fields at the Site File).

RESEARCH METHODS (Check all choices that apply; if needed write others at bottom)

- formal archaeological survey
- informal archaeological inspection
- Public Lands Survey (DEP)
- tax records/property deeds
- tax records only
- interior inspection
- other methods (specify) Longboat Key Historical Society Archives
- past surveys search at FMSF
- past sites search at FMSF
- FL Archives (Gray Building)
- FL Photo Archives (Gray Building)
- occupant/owner interview
- neighbor interview
- local library research
- non-local library research
- building permits
- demolition permits
- commercial permits
- occupation permits
- Sanborn maps
- subdivision maps
- plat maps
- local newspaper files

SURVEYOR'S EVALUATION OF SITE (Check one choice on each line)

Potentially eligible for local register?  yes: name register at right  no  insufficient info Name of local register if eligible:LBK

Individually eligible for National Register?  yes  no  insufficient info

Potential contributor to Nat. Reg. district?  yes  no  insufficient info

Area(s) of Historical Significance (See National Register Bulletin 15, p. 8 for categories: e.g. "architecture", "ethnic heritage", "community planning & development", etc.)

**Architecture and Planning and Community Development and Tourism** . . . . .

Explanation of Evaluation (required, whether positive or not; limit to three lines; attach longer statement, if needed, on separate sheet)

**The main block of this well preserved former Robinson/Long Beach resort cottage is unaltered. Minimum modifications to the structure include E and W porch enclosure and enlargement. The structure is very similar to a number of other LBK resort cottages. Therefore, it does not appear to be N.R. eligible.**

DOCUMENTATION (Photos, Plans, etc.)

Bibliographic References (Use Continuation Sheet, give FMSF Manuscript # if relevant) . . . . .

c1946 Long Beach Cottages promotional brochure with photos

Whitney, Lora, Hail This Feisty Village, Rainbow Press, Torrington, CT, 1984, 1992, pp. 80,87

Photographs (required) B&W print(s) at least 3 x 5, at least one main facade.

Location of negatives & negative numbers Longboat Key Historical Society . . . . .

RECORDER

Name (last name first) / Address / Phone / Fax / Email / Affiliation Mikki Hartig, Historical & Architectural Research Services, 3708 Flores Avenue, Sarasota, FL 34239 / 941-955-6028 . . . . .

Remember: Use a Supplement for Site Forms or other continuation sheet for descriptions that do not fit in the spaces above.

REQUIRED: (1) USGS 7.5' MAP WITH STRUCTURE PINPOINTED IN RED  
(2) LARGE SCALE STREET OR PLAT MAP

PHOTOGRAPH

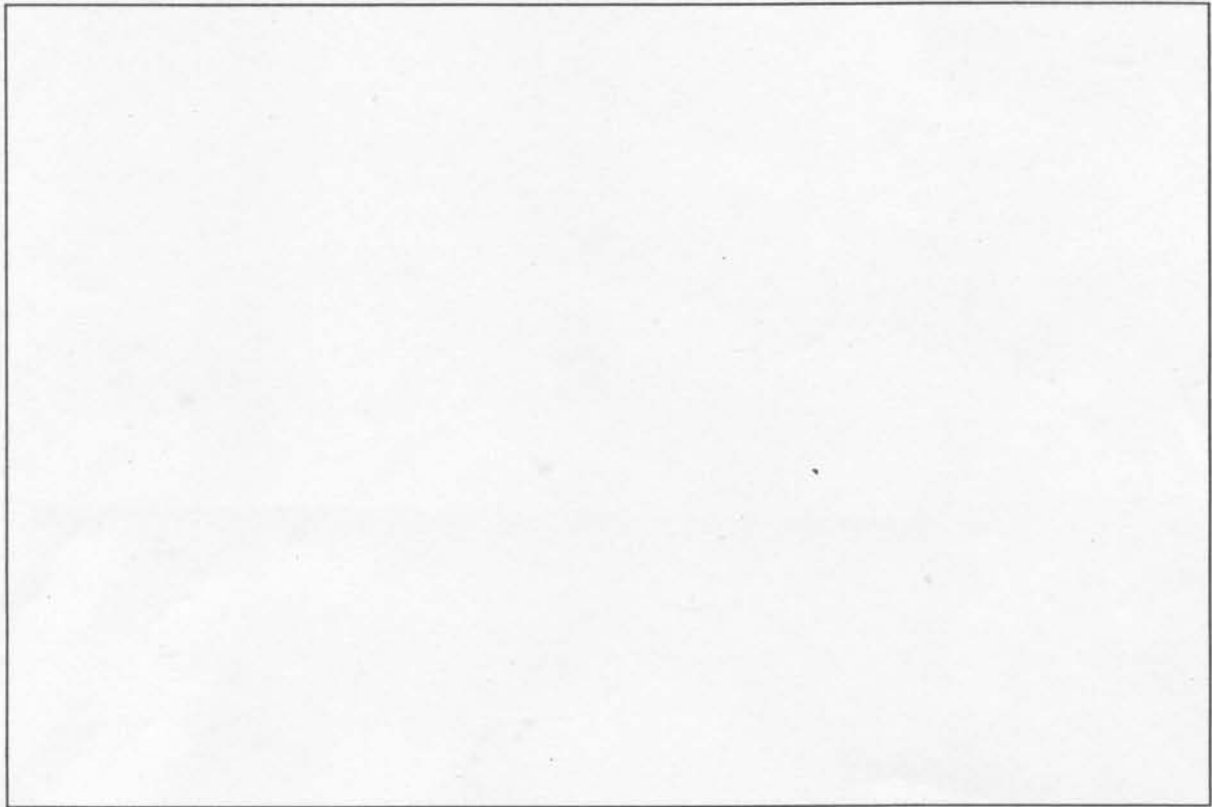

STREET OR PLAT MAP

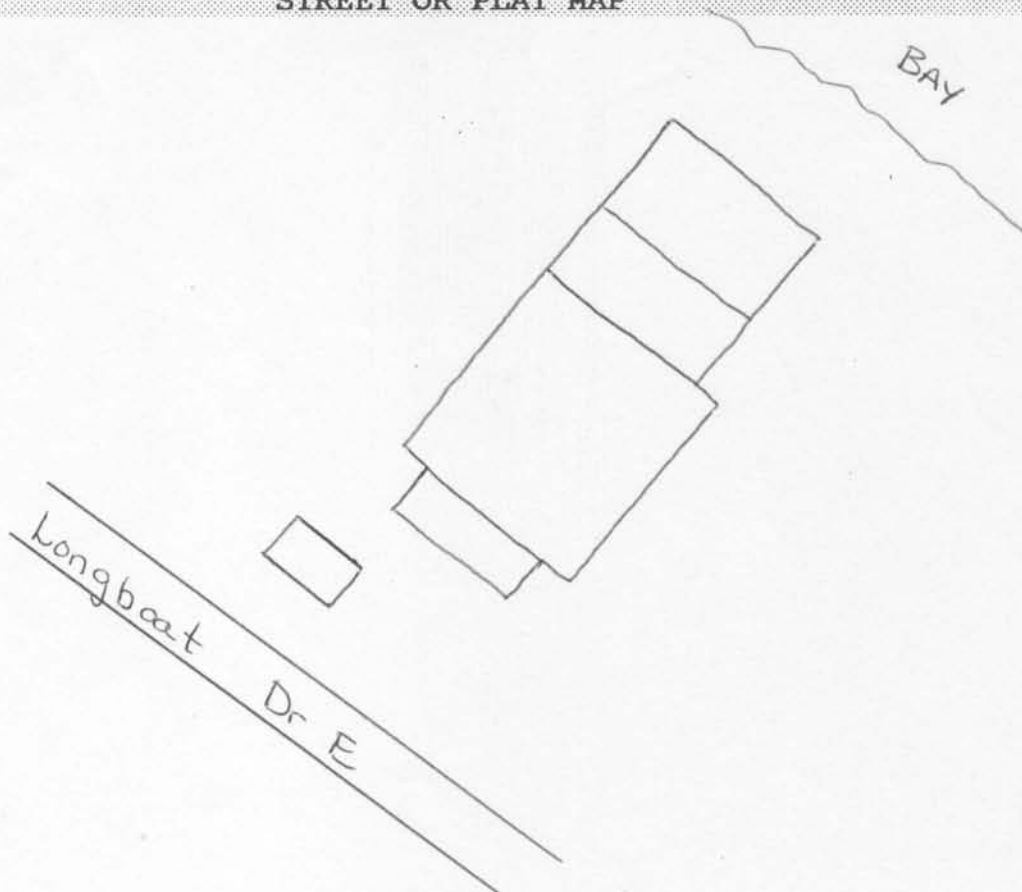

NORTH



NOT TO SCALE

USGS MAP



SCALE 1:24 000

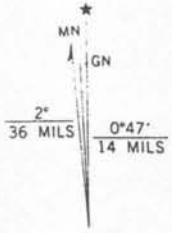
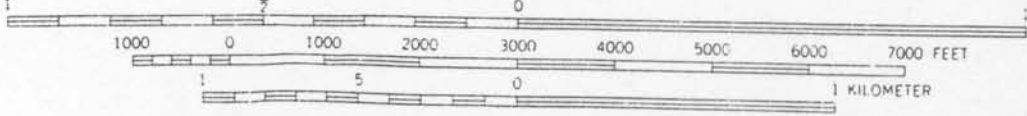

JTM GRID AND 1987 MAGNETIC NORTH DECLINATION AT CENTER OF SHEET



