

HISTORICAL STRUCTURE FORM

Site #8 MA-1085

x Original
o Update (give site #)

FLORIDA MASTER SITE FILE

Version 3.0 11/96

Recorder _____
FieldDate 01/03/99
FormDate 05/31/99

SiteName(s)address if none).Robinson/Long Beach Cottage 3. Multiple Listing [DHR only] _____

Survey **Longboat Key** Survey #
National Register Category (Please check one: consult with Site File before using last 4): building structure district site object

LOCATION & IDENTIFICATION

Address (Include N,S,E,W; #; St., Ave., etc.) **7130 Longboat Dr E**
Cross Streets (nearest /between) **Longboat Ct**
City / Town (within 3 miles) **Town of Longboat Key** In Current City Limits: y o n o unknown
County **Manatee** Tax Parcel #(s) **77991.0000/8**
Subdivision name **Longbeach** Block **.21** Lot **9**
Ownership (Please check one): private-profit private-individual city county Native American
 private-nonprofit private-unspecified state federal foreign unknown
Name of Public Tract (e.g., park)
Route to (especially if no street address)

MAPPING

USGS 7.5' Map Name & Date **Bradenton Beach, FL, 1964, PR 1987**
Township 35S Range 16E Section 15 ¼ section: NW SW SE NE Irregular-name: _____
Landgrant **Thomas Mann** UTM: Zone 16 X17 Easting **33464** 0 Northing **303549070** 0
Plat or other map (map's name, location) **Longbeach/Revision of Longboat Beach, 1914 - Manatee Cnty Prop Appraiser**

DESCRIPTION

Style* **Frame Vernacular** Exterior Plan* **rectangular** Number of Stories **1**
Structural System(s) ***wood frame**
Foundation: Type(s) * **piers** Material(s) * **Concrete Block**
Exterior Fabric(s) *
Roof: Type(s) * **Gable** Material(s) * **asphalt shingle**
Roof secondary strucs. (dormers etc.) *
Chimney: No. 1 Material(s) ***brick** Location(s) ***N. ext**
Windows (types, materials, etc.) ***alum casement, ind, paired**
Main Entrance (stylistic details)
Porches: #open 1 #closed 1 #incised _____ Location(s) **E & W**
Porch roof type(s)**gable**
Exterior Ornament **wood lattice on W porch addition**
Interior Plan* **Unknown**
Condition (Please check one): excellent good fair deteriorated ruinous
Surroundings (N=None, S=Some, M=Most, A=All/nearly all): N commercial A residential S institutional N undeveloped
Ancillary Features c1989 W. pool and garage
Archaeological Remains **None Observed** Check if Archaeological Form completed
* Consult Guide to Historical Structure Forms for preferred descriptions (coded fields at the Site File).

DHR USE ONLY \$\$\$\$\$\$ OFFICIAL EVALUATIONS \$\$\$\$\$\$ DHR USE ONLY

NR DATE Date ___/___/___	KEEPER-NR ELIGIBILITY _____	yes <input type="checkbox"/> no <input type="checkbox"/>
___/___/___	SHPO-NR ELIGIBILITY:	yes <input type="checkbox"/> no <input type="checkbox"/> potentially elig. <input type="checkbox"/> insufficient Info <input type="checkbox"/> Date ___/___/___
DELIST DATE ___/___/___	LOCAL DESIGNATION: Local office _____	Date ___/___/___
National Register Criteria for Evaluation <input type="checkbox"/> a <input type="checkbox"/> b <input type="checkbox"/> c <input type="checkbox"/> d (See National Register Bulletin 15, p. 2)		

Consult *Guide to Historical Structure Forms* for detailed instructions.

HISTORY

Construction date: Exactly _____ (year) Approximately 1933 (year) Earlier than _____ (year) Later than _____ (year)

Architect (last name first): Unknown Builder (last name first): Local Carpenters

Moves: yes no unknown Dates Original address

Alterations: yes no unknown Dates c1991 Nature* total siding rep

Additions: yes no unknown Dates c.1991 Nature* W. offset porch

Original Use* (give date ranges) **RESI**

Intermediate Uses* (give date ranges) **RESI**

Present Use* (give date ranges) **RESI**

Ownership History (especially original owner, dates, profession, etc.)

Robinson (1933-1948), Garman, Louis (1948-60s)

Alexander, Charles and Dianne (1989 - present)

* Consult *Guide to Historical Structure Forms* for preferred descriptions (coded fields at the Site File).

RESEARCH METHODS (Check all choices that apply; if needed write others at bottom)

- formal archaeological survey
- informal archaeological inspection
- Public Lands Survey (DEP)
- tax records/property deeds
- tax records only
- interior inspection
- other methods (specify) Longboat Key Historical Society Archives
- past surveys search at FMSF
- past sites search at FMSF
- FL Archives (Gray Building)
- FL Photo Archives (Gray Building)
- occupant/owner interview
- neighbor interview
- local library research
- non-local library research
- building permits
- demolition permits
- commercial permits
- occupation permits
- Sanborn maps
- subdivision maps
- plat maps
- local newspaper files

SURVEYOR'S EVALUATION OF SITE (Check one choice on each line)

Potentially eligible for local register? yes: name register at right no insufficient info Name of local register if eligible:

Individually eligible for National Register? yes no insufficient info

Potential contributor to Nat. Reg. district? yes no insufficient info

Area(s) of Historical Significance (See *National Register Bulletin 15*, p. 8 for categories: e.g. "architecture", "ethnic heritage", "community planning & development", etc.)

Architecture and Planning and Community Dev and Tourism

Explanation of Evaluation (required, whether positive or not; limit to three lines; attach longer statement, if needed, on separate sheet)

This simple Frame Vernacular residence, although of note for being an early resort cottage, has been modified with total window and siding replacement in 1991. Therefore, these modifications appear to preclude it from N.R. eligibility.

DOCUMENTATION (Photos, Plans, etc.)

Bibliographic References (Use Continuation Sheet, give FMSF Manuscript # if relevant)

c1946 Long Beach Cottages promotional brochure with photos
Whitney, Lora, Hail This Feisty Village, Rainbow Press, Torrington, CT, 1984, 1992, pp. 80, 87

Photographs (required) B&W print(s) at least 3 x 5, at least one main facade.

Location of negatives & negative numbers **Longboat Key Historical Society** # 13/9, 10

RECORDER

Name (last name first) / Address / Phone / Fax / Email / Affiliation **Mikki Hartig, Historical & Architectural Research Services, 3708 Flores Avenue, Sarasota, FL 34239 / 941-955-6028**

Remember: Use a *Supplement for Site Forms* or other continuation sheet for descriptions that do not fit in the spaces above.

REQUIRED:

- (1) USGS 7.5' MAP WITH STRUCTURE PINPOINTED IN RED**
- (2) LARGE SCALE STREET OR PLAT MAP**
- (3) PHOTO OF MAIN FACADE, PREFER B&W, AT LEAST 3X5**

PHOTOGRAPH

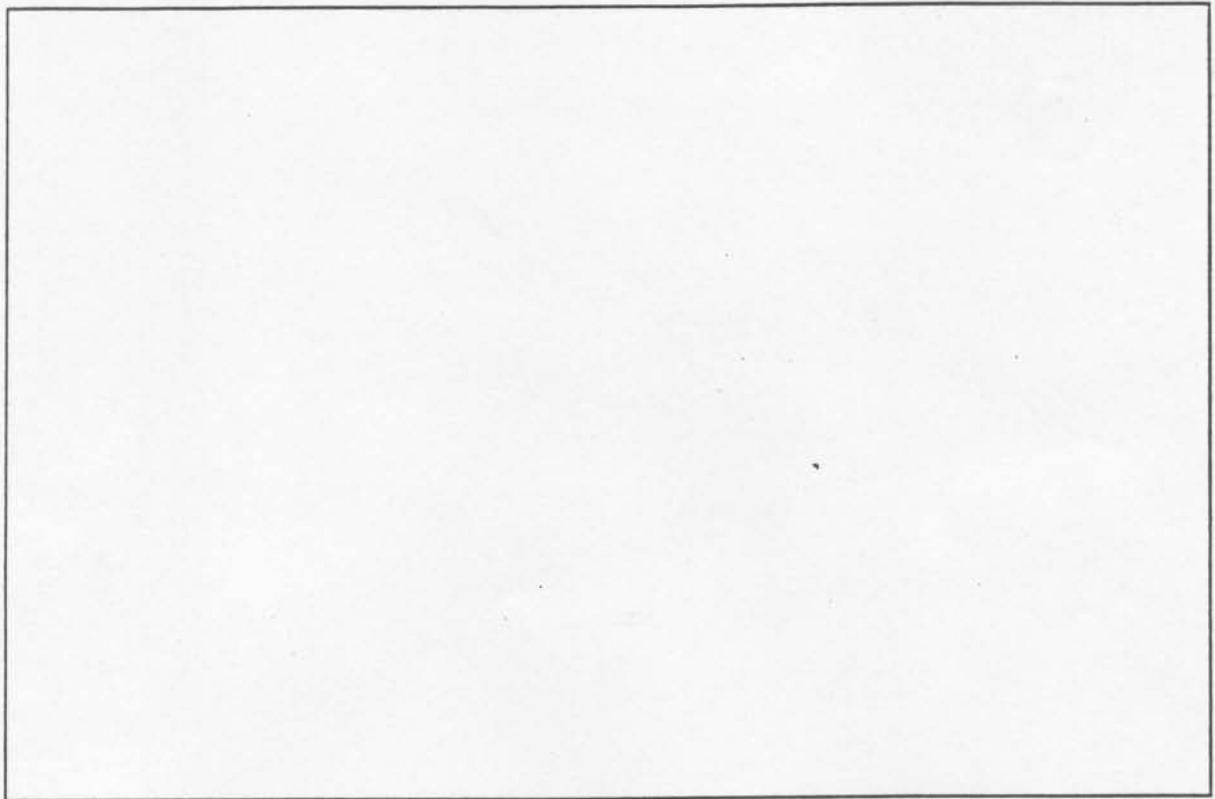

STREET OR PLAT MAP

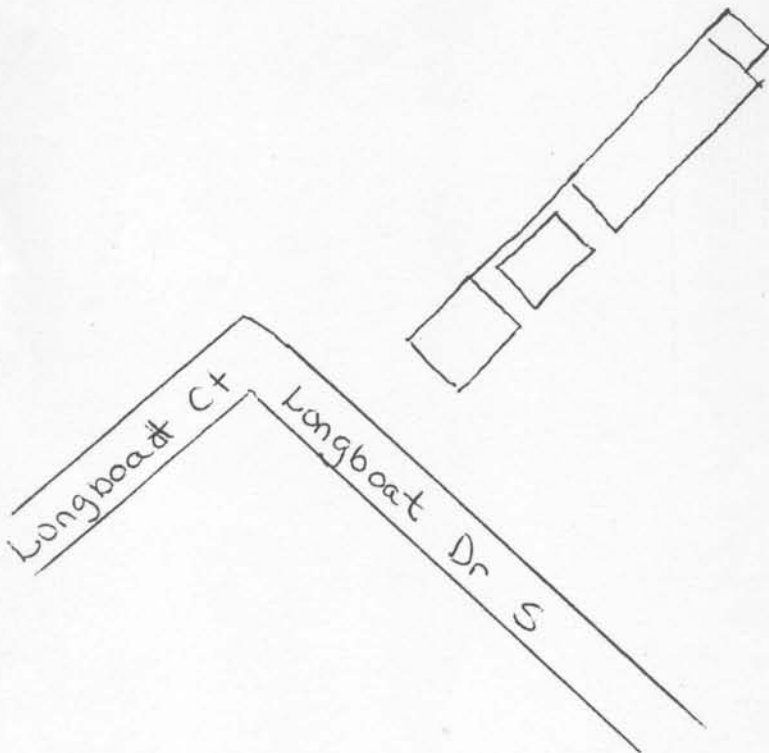

NOT TO SCALE

USGS MAP



SCALE 1:24 000

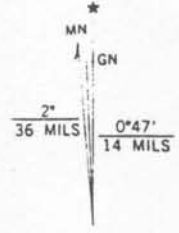
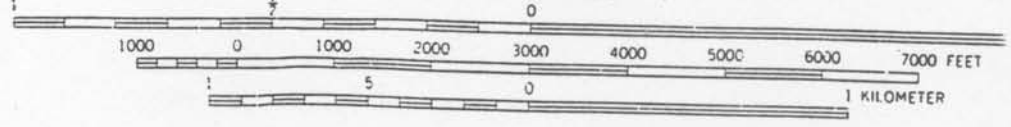

JTM GRID AND 1987 MAGNETIC NORTH DECLINATION AT CENTER OF SHEET

