

HISTORICAL STRUCTURE FORM

Site #8 MA-1089

x Original
o Update (give site #)

FLORIDA MASTER SITE FILE

Version 3.0 11/96

Recorder

FieldDate 01/03/99

FormDate 05/31/99

SiteName(s)address if none).Robinson/Long Beach Cottage #1. Multiple Listing [DHR only]

Survey Longboat Key Survey #
National Register Category (Please check one: consult with Site File before using last 4): X building o structure o district o site o object

LOCATION & IDENTIFICATION

Address (Include N,S,E,W; #; St., Ave., etc.) 7110 Longboat Dr E
Cross Streets (nearest / between) Fox St
City / Town (within 3 miles) Town of Longboat Key In Current City Limits: X y o n o unknown
County Manatee Tax Parcel #(s) 77989.0000/2
Subdivision name Longbeach Block .21 Lot 7
Ownership (Please check one): o private-profit X private-individual o city o county o Native American
o private-nonprofit o private-unspecified o state o federal o foreign o unknown
Name of Public Tract (e.g., park)
Route to (especially if no street address)

MAPPING

USGS 7.5' Map Name & Date Bradenton Beach, FL, 1964, PR 1987
Township 35S Range 16E Section 15 1/4 section: o NW o SW X SE o NE o Irregular-name:
Landgrant Thomas Mann UTM: Zone o16 X17 Easting 33464 0 Northing 303549070 0
Plat or other map (map's name, location) Longbeach/Revision of Longboat Beach, 1914 - Manatee Cnty Prop Appraiser

DESCRIPTION

Style* Frame Vernacular Exterior Plan* rectangular Number of Stories 1
Structural System(s) *wood frame
Foundation: Type(s) * piers Material(s) * Concrete Block
Exterior Fabric(s) * asbestos siding
Roof: Type(s) * Gable Material(s) * asphalt shingle
Roof secondary strucs. (dormers etc.)*
Chimney: No. 1 Material(s) *brick Location(s) *N. ext
Windows (types, materials, etc.) *1/1 wood dhs ind; 3 light alum awning, grouped
Main Entrance (stylistic details)
Porches: #open 1 #closed 1 #incised Location(s) E & W
Porch roof type(s) shed and gable
Exterior Ornament exposed rafter tails, metal attic vent
Interior Plan* Unknown
Condition (Please check one): X excellent o good o fair o deteriorated o ruinous
Surroundings (N=None, S=Some, M=Most, A=All/nearly all): N commercial A residential S institutional N undeveloped
Ancillary Features
Archaeological Remains None Observed o Check if Archaeological Form completed
* Consult Guide to Historical Structure Forms for preferred descriptions (coded fields at the Site File).

DHR USE ONLY OFFICIAL EVALUATIONS DHR USE ONLY

Form with fields for NR DATE, KEEPER-NR ELIGIBILITY, SHPO-NR ELIGIBILITY, LOCAL DESIGNATION, and National Register Criteria for Evaluation.

HISTORY

Construction date: Exactly _____(year) Approximately 1933 (year) Earlier than _____(year) Later than _____(year)

Architect (last name first): Unknown Builder (last name first): Local Carpenters

Moves: yes no unknown Dates Original address

Alterations: yes no unknown Dates c.1970 Nature* **E. porch enc**

Additions: yes no x unknown Dates Nature*

Original Use* (give date ranges) RESI

Intermediate Uses* (give date ranges) RESI

Present Use* (give date ranges) RESI

Ownership History (especially original owner, dates, profession, etc.)

Robinson (c.1933-1948); Garman, Louis (1948-60s)

Christensen, Harold and Lynn (1998-present)

* Consult Guide to Historical Structure Forms for preferred descriptions (coded fields at the Site File).

RESEARCH METHODS (Check all choices that apply; if needed write others at bottom)

- formal archaeological survey
- informal archaeological inspection
- Public Lands Survey (DEP)
- tax records/property deeds
- tax records only
- interior inspection
- other methods (specify) **Longboat Key Historical Society Archives**
- past surveys search at FMSF
- past sites search at FMSF
- FL Archives (Gray Building)
- FL Photo Archives (Gray Building)
- occupant/owner interview
- neighbor interview
- local library research
- non-local library research
- building permits
- demolition permits
- commercial permits
- occupation permits
- Sanborn maps
- subdivision maps
- plat maps
- local newspaper files

SURVEYOR'S EVALUATION OF SITE (Check one choice on each line)

Potentially eligible for local register? yes: name register at right no insufficient info Name of local register if eligible: **LBK**

Individually eligible for National Register? yes no insufficient info

Potential contributor to Nat. Reg. district? yes no insufficient info

Area(s) of Historical Significance (See National Register Bulletin 15, p. 8 for categories: e.g. "architecture", "ethnic heritage", "community planning & development", etc.)

Architecture and Community Planning and Development and Tourism

Explanation of Evaluation (required, whether positive or not; limit to three lines; attach longer statement, if needed, on separate sheet)

This former Robinson/Long Beach cottage is minimally altered. It was originally one of the original Long Beach Cottages, but is similar to a number of other period LBK structures, therefore, it does not appear to be N.R. eligible.

DOCUMENTATION (Photos, Plans, etc.)

Bibliographic References (Use Continuation Sheet, give FMSF Manuscript # if relevant)
c1946 Long Beach Cottages promotional brochure with photos

Photographs (required) B&W print(s) at least 3 x 5, at least one main facade.

Location of negatives & negative numbers **Longboat Key Historical Society**

RECORDER

Name (last name first) / Address / Phone / Fax / Email / Affiliation **Mikki Hartig, Historical & Architectural Research Services, 3708 Flores Avenue, Sarasota, FL 34239 / 941-955-6028**

Remember: Use a Supplement for Site Forms or other continuation sheet for descriptions that do not fit in the spaces above.

| | |
|------------------|---|
| REQUIRED: | (1) USGS 7.5' MAP WITH STRUCTURE PINPOINTED IN RED (2) LARGE SCALE STREET OR PLAT MAP (3) PHOTO OF MAIN FACADE, PREFER B&W, AT LEAST 3X5 |
|------------------|---|

USGS MAP



SCALE 1:24 000

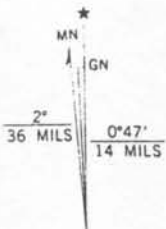
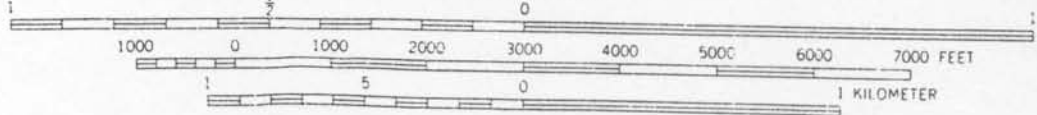

PHOTOGRAPH

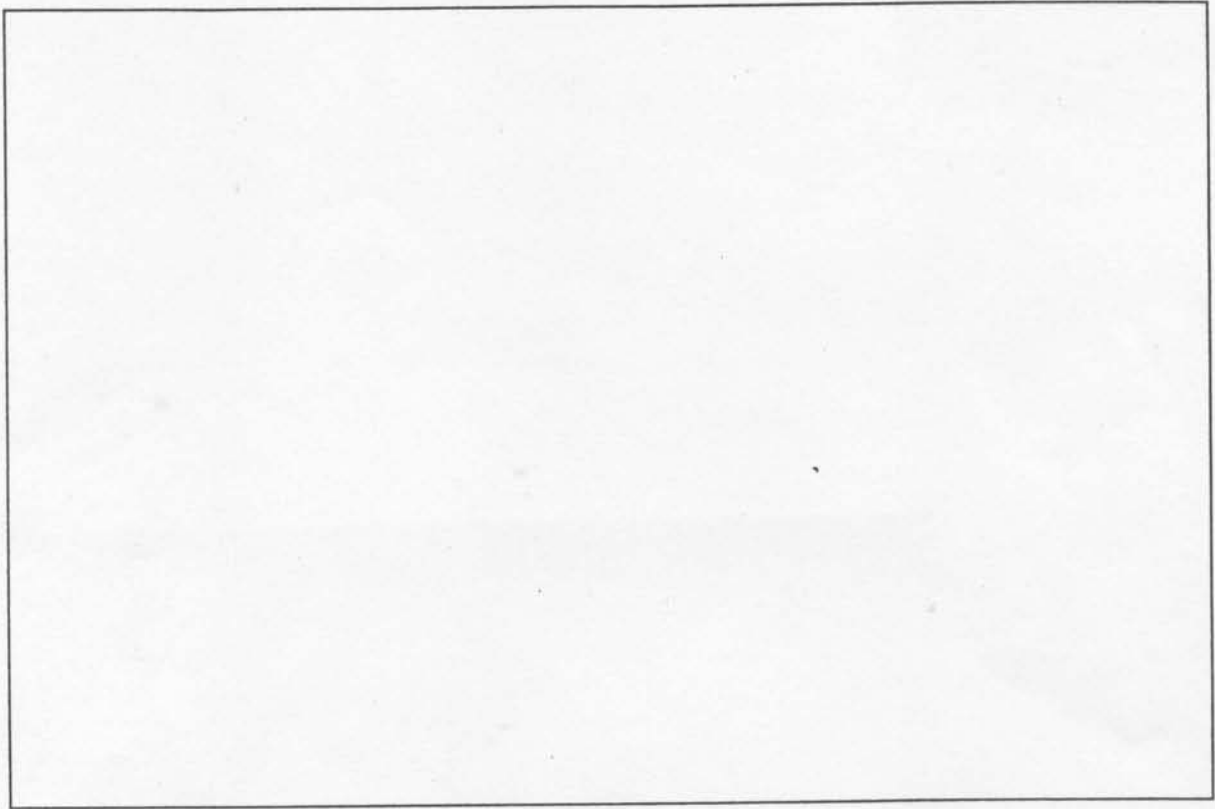

STREET OR PLAT MAP

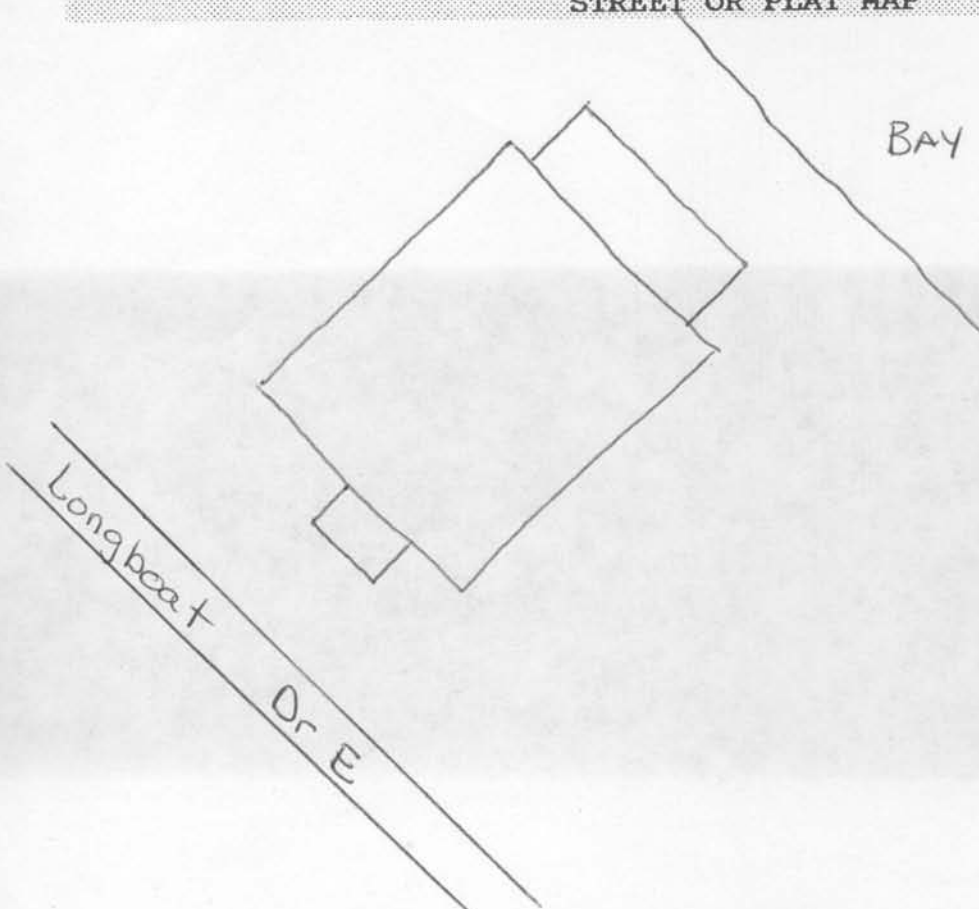

NOT TO SCALE

