

HISTORICAL STRUCTURE FORM

Site #8 MA-1054

x Original
o Update (give site #)

FLORIDA MASTER SITE FILE

Recorder

Version 3.0 11/96

FieldDate 01/03/99

FormDate 05/31/99

SiteName(s)address if none).Robinson/Long Beach Cottage 8. Multiple Listing [DHR only]

Survey Longboat Key Survey #
National Register Category (Please check one: consult with Site File before using last 4): X building o structure o district o site o object

LOCATION & IDENTIFICATION

Address (Include N,S,E,W; #; St., Ave., etc.) 7091 Longboat Dr E.
Cross Streets (nearest /between) Fox St
City / Town (within 3 miles) Town of Longboat Key In Current City Limits: X y o n o unknown
County Manatee Tax Parcel #(s) 77932.0000/2
Subdivision name Longbeach Block 18 Lot 1
Ownership (Please check one): o private-profit X private-individual o city o county o Native American
o private-nonprofit o private-unspecified o state o federal o foreign o unknown
Name of Public Tract (e.g., park)
Route to (especially if no street address)

MAPPING

USGS 7.5' Map Name & Date Bradenton Beach, FL, 1964, PR 1987
Township 35S Range 16E Section 15 1/4 section: o NW o SW X SE o NE o Irregular-name:
Landgrant Thomas Mann UTM: Zone o16 X17 Easting 33464 0 Northing 303549070 0
Plat or other map (map's name, location) Longbeach/Revision of Longboat Beach, 1914 - Manatee Cnty Prop Appraiser

DESCRIPTION

Style* Frame Vernacular Exterior Plan* modified square Number of Stories 1
Structural System(s) * C.B. and wood frame
Foundation: Type(s) * Continuous Material(s) * Concrete Block
Exterior Fabric(s) * wood drop siding and stucco
Roof: Type(s) * Gable Material(s) * metal
Roof secondary strucs. (dormers etc.) *
Chimney: No. 0 Material(s) * Location(s) *
Windows (types, materials, etc.) *1/1 alum shs, ind and paired; 2 light alum awning
Main Entrance (stylistic details)
Porches: #open 3 #closed #incised Location(s) E.&W; integrated wrap around on W
Porch roof type(s)
Exterior Ornament
Interior Plan* Unknown
Condition (Please check one): X excellent o good o fair o deteriorated o ruinous
Surroundings (N=None, S=Some, M=Most, A=All/nearly all): N commercial A residential S institutional N undeveloped
Ancillary Features
Archaeological Remains None Observed o Check if Archaeological Form completed
* Consult Guide to Historical Structure Forms for preferred descriptions (coded fields at the Site File).

DHR USE ONLY \$\$\$\$\$\$ OFFICIAL EVALUATIONS \$\$\$\$\$\$ DHR USE ONLY

Form with fields for NR DATE, KEEPER-NR ELIGIBILITY, SHPO-NR ELIGIBILITY, LOCAL DESIGNATION, and National Register Criteria for Evaluation.

HISTORY

Construction date: Exactly _____(year) Approximately 1920 (year) Earlier than _____(year) Later than _____(year)

Architect (last name first): Unknown Builder (last name first): Local Carpenters

Moves: yes no unknown Dates c1993 Original address unknown

Alterations: yes no unknown Dates c.1993 Nature* elevated, total window and siding replacement, soffit encl

Additions: yes no unknown Dates c.1993 Nature* E. entr stairs; shed roof porch on SE; L-shaped deck

Original Use* (give date ranges) RESI

Intermediate Uses* (give date ranges) RESI

Present Use* (give date ranges) RESI

Ownership History (especially original owner, dates, profession, etc.)

Robinson (1940-48), Garman, Louis (1948-?)

Chinnis, Russell, Killeen, Christine (present)

* Consult Guide to Historical Structure Forms for preferred descriptions (coded fields at the Site File).

RESEARCH METHODS (Check all choices that apply; if needed write others at bottom)

- formal archaeological survey past surveys search at FMSF local library research Sanborn maps
- informal archaeological inspection past sites search at FMSF non-local library research subdivision maps
- Public Lands Survey (DEP) FL Archives (Gray Building) building permits plat maps
- tax records/property deeds FL Photo Archives (Gray Building) demolition permits local newspaper files
- tax records only occupant/owner interview commercial permits
- interior inspection neighbor interview occupation permits
- other methods (specify) Longboat Key Historical Society Archives

SURVEYOR'S EVALUATION OF SITE (Check one choice on each line)

Potentially eligible for local register? yes: name register at right no insufficient info Name of local register if eligible:

Individually eligible for National Register? yes no insufficient info

Potential contributor to Nat. Reg. district? yes no insufficient info

Area(s) of Historical Significance (See National Register Bulletin 15, p. 8 for categories: e.g. "architecture", "ethnic heritage", "community planning & development", etc.)

Architecture and Planning and Community Development

Explanation of Evaluation (required, whether positive or not; limit to three lines; attach longer statement, if needed, on separate sheet)

This originally modest Frame Vernacular resort cottage was elevated above floodplain c.1993, at which time total window and siding replacement occurred and porch additions. Based upon elevated state, it does not appear to be N.R. eligible.

DOCUMENTATION (Photos, Plans, etc.)

Bibliographic References (Use Continuation Sheet, give FMSF Manuscript # if relevant)

Whitney, Lora, Hail This Feisty Village, Rainbow Press, Torrington, CT, 1984, 1992, pp 80
c1946 Long Beach Cottages promotional brochure with photos

Photographs (required) B&W print(s) at least 3 x 5, at least one main facade.

Location of negatives & negative numbers Longboat Key Historical Society

RECORDER

Name (last name first) / Address / Phone / Fax / Email / Affiliation Mikki Hartig, Historical & Architectural Research Services, 3708 Flores Avenue, Sarasota, FL 34239 / 941-955-6028

Remember: Use a Supplement for Site Forms or other continuation sheet for descriptions that do not fit in the spaces above.

- REQUIRED:
- (1) USGS 7.5' MAP WITH STRUCTURE PINPOINTED IN RED**
 - (2) LARGE SCALE STREET OR PLAT MAP**
 - (3) PHOTO OF MAIN FACADE, PREFER B&W, AT LEAST 3X5**

PHOTOGRAPH

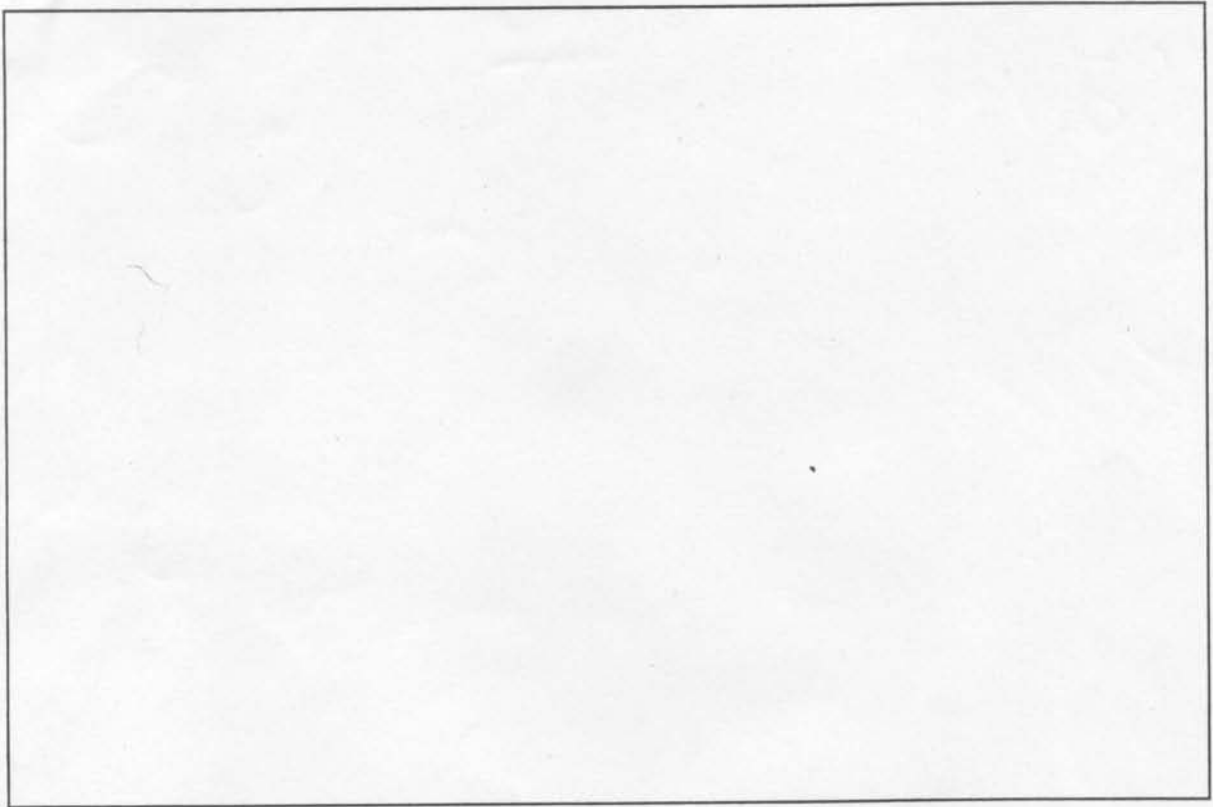

STREET OR PLAT MAP

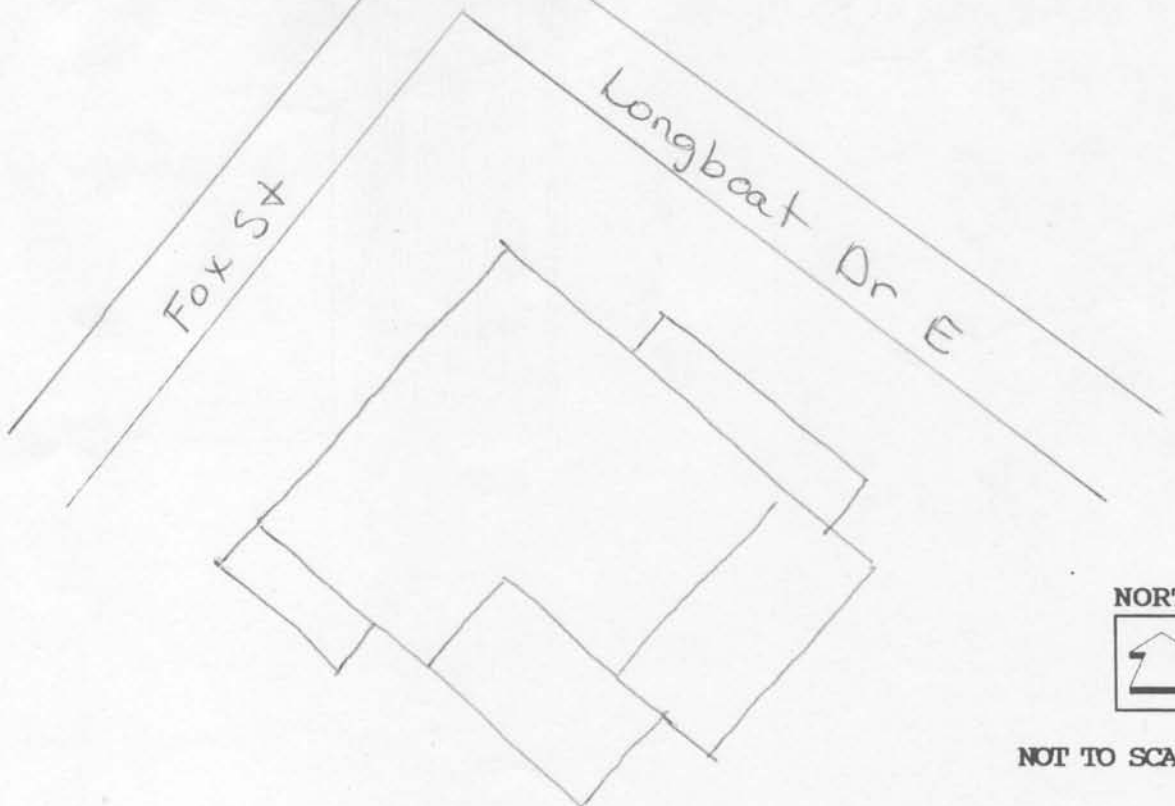

USGS MAP

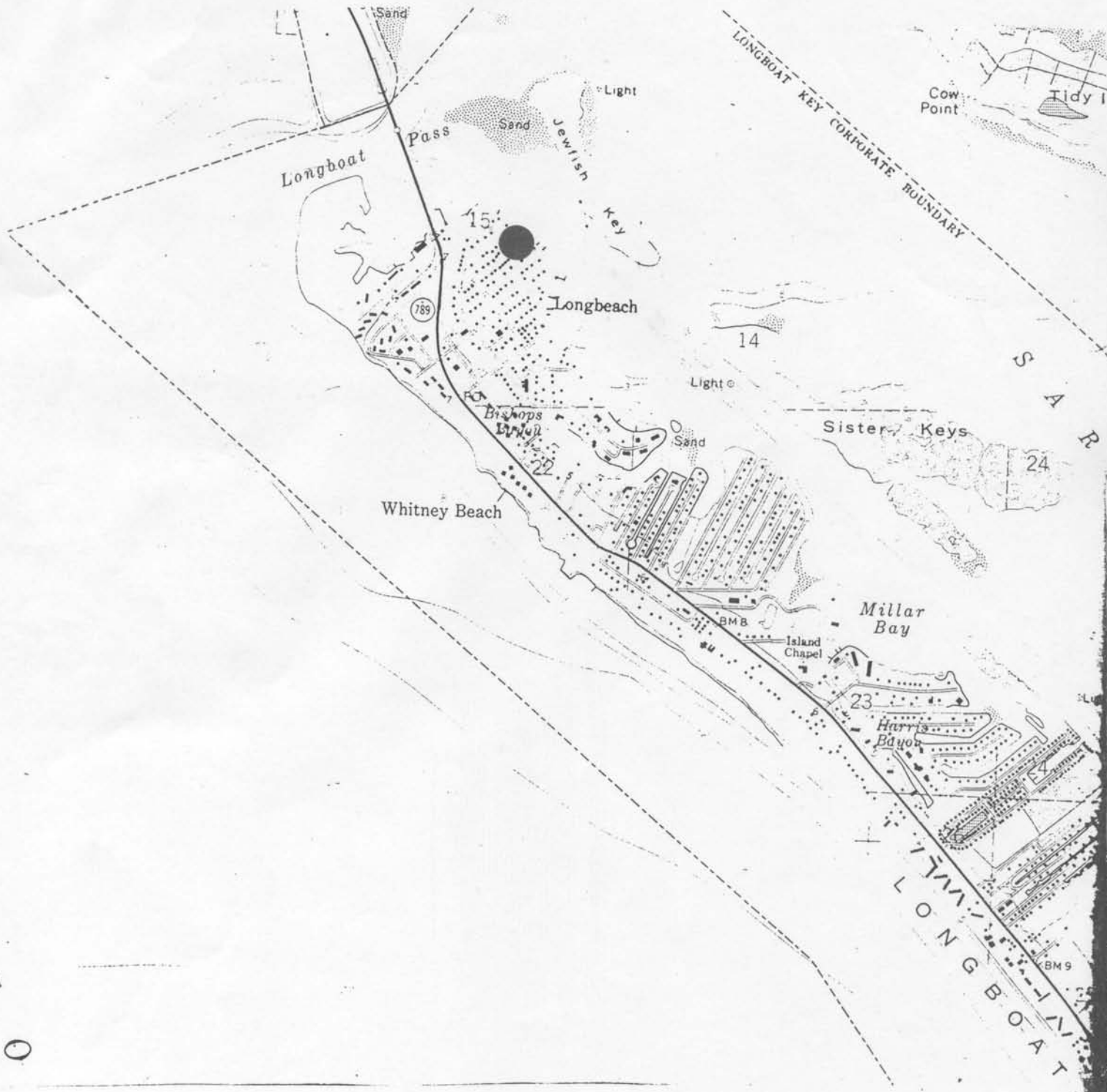

SCALE 1:24 000

