

HISTORICAL STRUCTURE FORM

Site #8 MA-1050

FLORIDA MASTER SITE FILE

Recorder _____

x Original

Version 3.0 11/96

FieldDate 01/03/99

o Update (give site #)

FormDate 05/31/99

SiteName(s)address if none).Whitney Beach Cottage 4 and Superintendents House. . Multiple Listing [DHR only]

Survey Longboat Key Survey # National Register Category (Please check one: consult with Site File before using last 4): X building o structure o district o site o object

LOCATION & IDENTIFICATION

Address (Include N,S,E,W; #; St., Ave., etc.) 6989 Longboat Dr S Cross Streets (nearest /between) Broadway City / Town (within 3 miles) Town of Longboat Key In Current City Limits: X y o n o unknown County Manatee Tax Parcel #(s) 77825.00005/7 Subdivision name Longbeach Block 10 Lot 2,3 Ownership (Please check one): o private-profit X private-individual o city o county o Native American o private-nonprofit o private-unspecified o state o federal o foreign o unknown Name of Public Tract (e.g., park) Route to (especially if no street address)

MAPPING

USGS 7.5' Map Name & Date Bradenton Beach, FL, 1964, PR 1987 Township 35S Range 16E Section 15 1/4 section: o NW o SW X SE o NE o Irregular-name: Landgrant Thomas Mann UTM: Zone o16 X17 Easting 33464 0 Northing 303549070 0 Plat or other map (map's name, location) Longbeach/Revision of Longboat Beach, 1914 - Manatee Cnty Prop Appraiser

DESCRIPTION

Style*Frame Vernacular Exterior Plan* irregular U Number of Stories 2 Structural System(s) * wood frame Foundation: Type(s) * piers Material(s) * Concrete and wood Exterior Fabric(s) *board and batten and beveled cypress siding Roof: Type(s) * hip and shed Material(s) * metal tile Roof secondary strucs. (dormers etc.) * Chimney: No._0_ Material(s) * Location(s) * Windows (types, materials, etc.) *6/1 wood dhs, ind, paired and ribbon; single light wood casement, ind; 1/1 wood dhs;8/8 alum shs, ind;10 light fixed, paired; 9 light octagonal window Main Entrance (stylistic details) Porches: #open_1_ #closed_ #incised_ Location(s) S side Porch roof type(s) Exterior Ornament foundation skirt, louvered gable vent Interior Plan* Unknown Condition (Please check one): X excellent o good ofair odeteriorated oruinous Surroundings (N=None, S=Some, M=Most, A=All/nearly all): N commercial A residential S institutional N undeveloped Ancillary Features c.1980 boathouse on W. Archaeological Remains None Observed o Check if Archaeological Form completed * Consult Guide to Historical Structure Forms for preferred descriptions (coded fields at the Site File).

DHR USE ONLY \$\$\$\$\$\$ OFFICIAL EVALUATIONS \$\$\$\$\$\$ DHR USE ONLY

Table with columns for NR DATE, KEEPER-NR ELIGIBILITY, SHPO-NR ELIGIBILITY, LOCAL DESIGNINATION, and DELIST DATE. Includes checkboxes for oyes, ono, opotentially elig., oinsufficient Info, and Date.

HISTORY

Construction date: Exactly _____(year) Approximately 1936 (year) Earlier than _____(year) Later than _____(year)
Architect (last name first): Kannenberg, Werner Builder (last name first): Local Carpenters
Moves: yes no unknown . . . Dates 1962 Original address Whitney Beach, LBK
Alterations: yes no unknown Dates: 1962, 1986, 1992 Nature* window replacement and new roof
Additions: yes no unknown Dates: 1978, 1986 Nature* W. 2-story addition; wood decks
Original Use* (give date ranges) RESI
Intermediate Uses* (give date ranges) RESI

Present Use* (give date ranges) RESI
Ownership History (especially original owner, dates, profession, etc.) Whitney, Gordon (c1936-62); Clark, Dorothy (1962-76);

Arends, John and Patricia (1976-present)
* Consult Guide to Historical Structure Forms for preferred descriptions (coded fields at the Site File).

RESEARCH METHODS (Check all choices that apply; if needed write others at bottom)

- formal archaeological survey
- informal archaeological inspection
- Public Lands Survey (DEP)
- tax records/property deeds
- tax records only
- interior inspection
- other methods (specify) Longboat Key Historical Society Archives
- past surveys search at FMSF
- past sites search at FMSF
- FL Archives (Gray Building)
- FL Photo Archives (Gray Building)
- occupant/owner interview
- neighbor interview
- local library research
- non-local library research
- building permits
- demolition permits
- commercial permits
- occupation permits
- Sanborn maps
- subdivision maps
- plat maps
- local newspaper files

SURVEYOR'S EVALUATION OF SITE (Check one choice on each line)

Potentially eligible for local register? yes: name register at right no insufficient info Name of local register if eligible:
Individually eligible for National Register? yes no insufficient info
Potential contributor to Nat. Reg. district? yes no insufficient info
Area(s) of Historical Significance (See National Register Bulletin 15, p. 8 for categories: e.g. "architecture", "ethnic heritage", "community planning & development", etc.)

Architecture, Community Planning and Development, and Tourism

Explanation of Evaluation (required, whether positive or not; limit to three lines; attach longer statement, if needed, on separate sheet)
Research reveals that this residence is comprised of four original Whitney Beach structures that were moved to this site in 1962. Although some elevations convey their original historic appearance, a number of contemporary, c.1986 additions have compromised the structures original historic integrity. Therefore, it does not appear to be N.R. eligilbe.

DOCUMENTATION (Photos, Plans, etc.)

Bibliographic References (Use Continuation Sheet, give FMSF Manuscript # if relevant)
On site interview with Mr. and Mrs. Arends, owners, 7/24/99
Whitney, Lora, Hail This Feisty Village, Rainbow Press, Torrington, CT, 1984, 1992, pp.8,40-43,45-48,53,54,63,64,67,69,75,76,78-80,96,97,112
Photographs (required) B&W print(s) at least 3 x 5, at least one main facade. 10/1-5
Location of negatives & negative numbers Longboat Key Historical Society

RECORDER

Name (last name first) / Address / Phone / Fax / Email / Affiliation Mikki Hartig, Historical & Architectural Research Services, 3708 Flores Avenue, Sarasota, FL 34239 / 941-955-6028

Remember: Use a Supplement for Site Forms or other continuation sheet for descriptions that do not fit in the spaces above.

- REQUIRED:
- (1) USGS 7.5' MAP WITH STRUCTURE PINPOINTED IN RED
 - (2) LARGE SCALE STREET OR PLAT MAP
 - (3) PHOTO OF MAIN FACADE, PREFER B&W, AT LEAST 3X5

PHOTOGRAPH

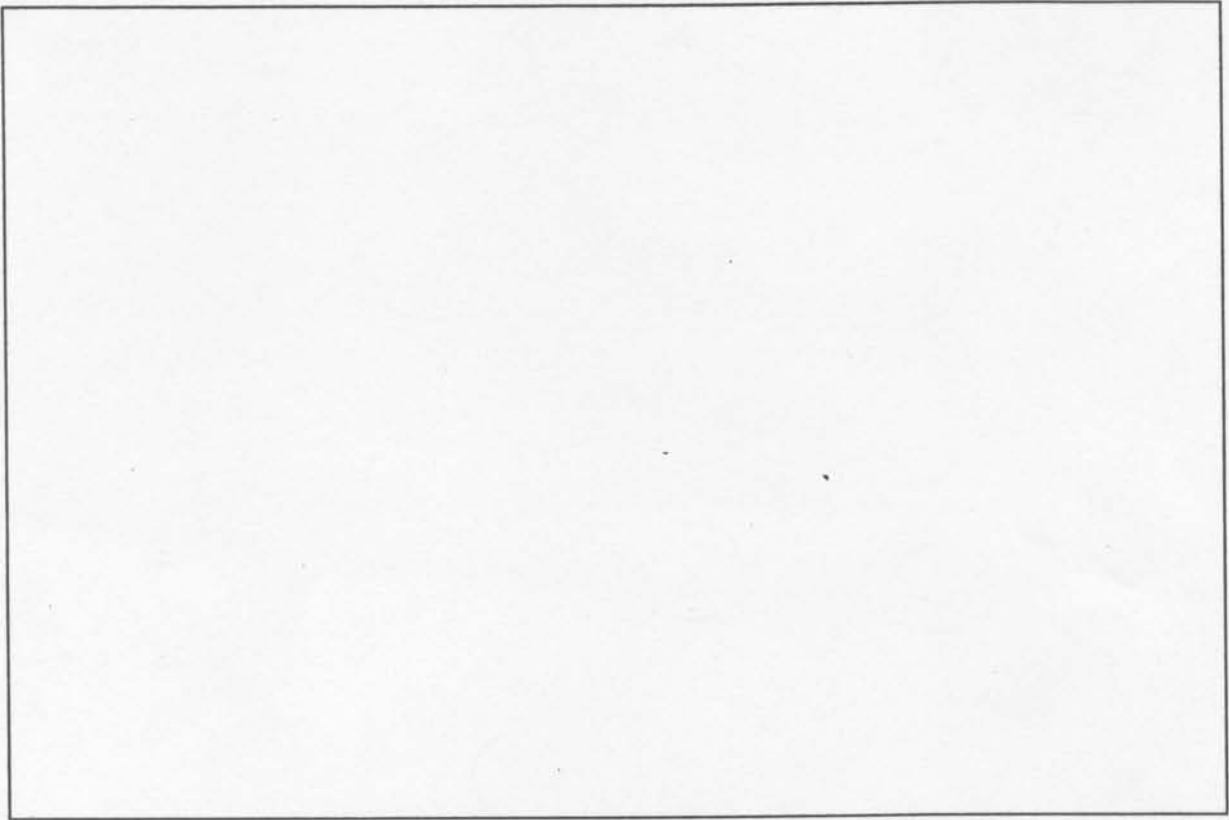

STREET OR PLAT MAP

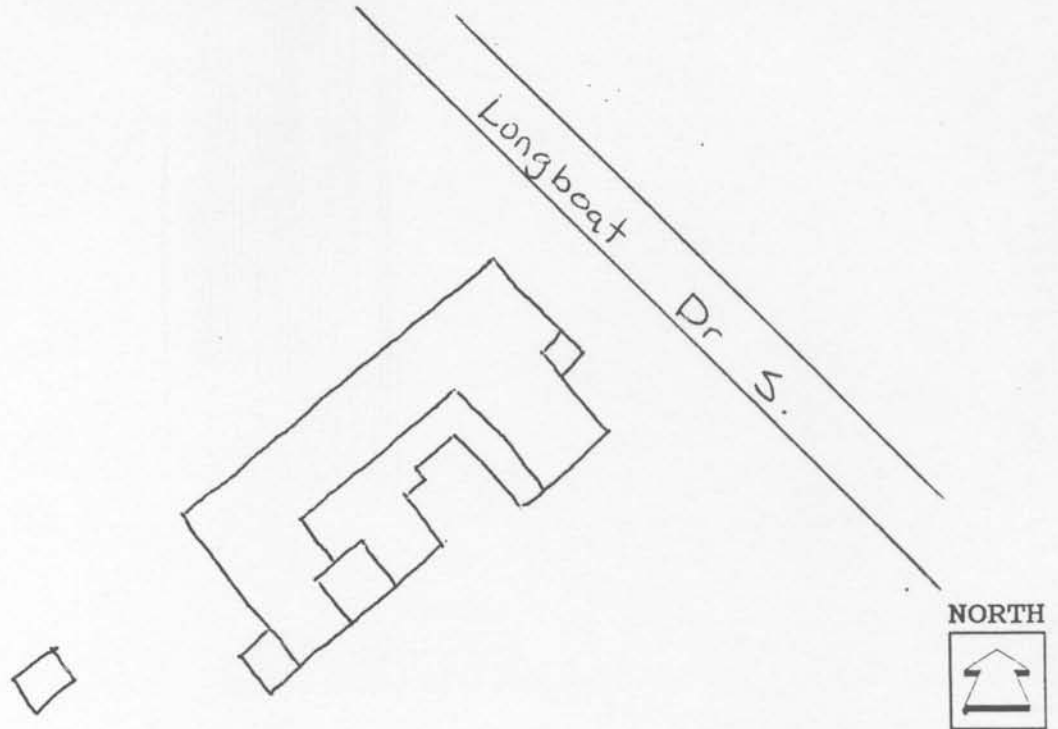

NOT TO SCALE

USGS MAP

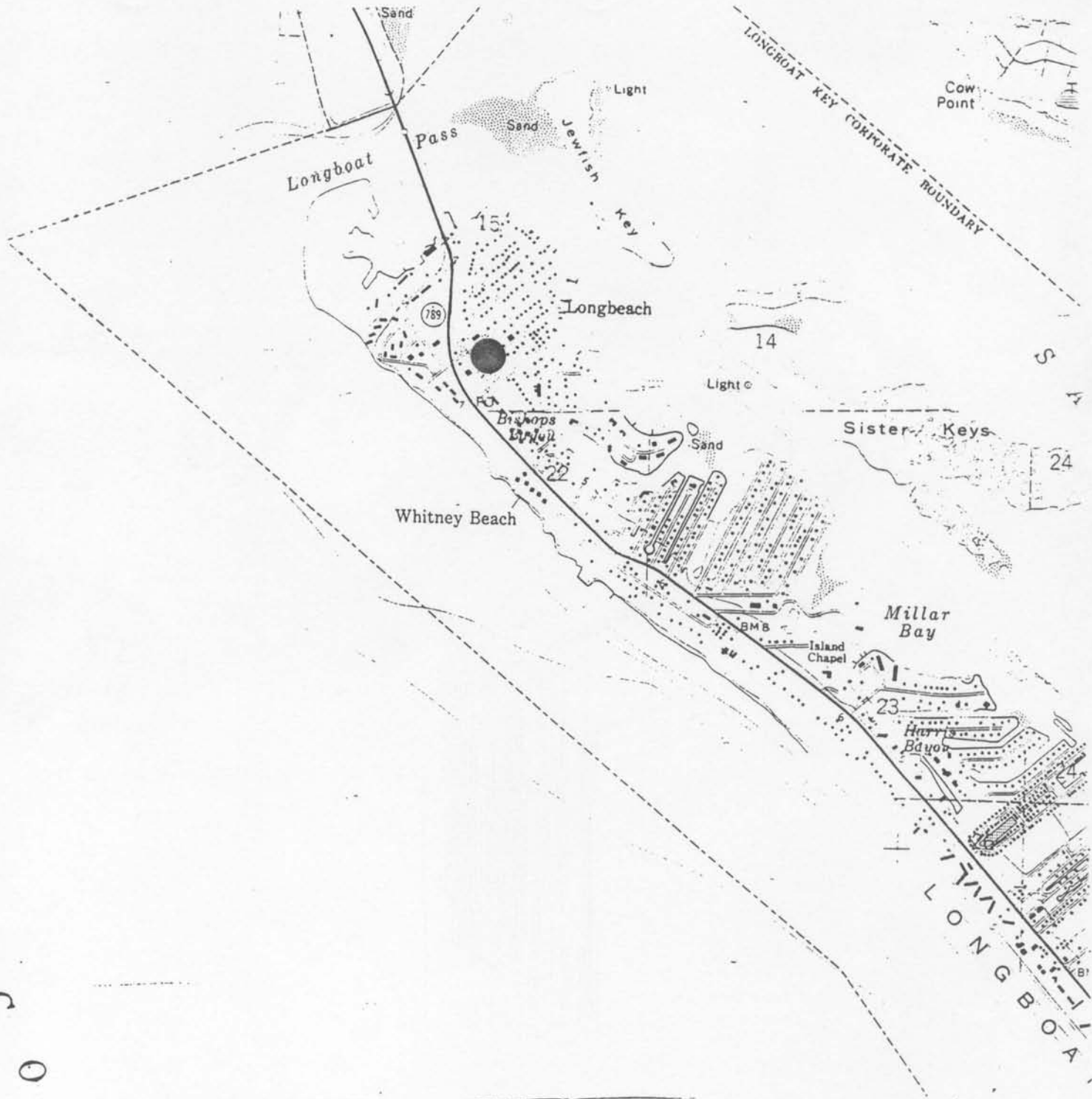

SCALE 1:24 000

