

HISTORICAL STRUCTURE FORM
FLORIDA MASTER SITE FILE

Site #8 MA-1022
Recorder
FieldDate 01/03/99
FormDate 05/31/99

x Original
o Update (give site #)

Version 3.0 11/96

SiteName(s)address if none).Whitney Beach Cottage #8. Multiple Listing [DHR only]

Survey Longboat Key Survey #
National Register Category (Please check one: consult with Site File before using last 4): X building o structure o district o site o object

LOCATION & IDENTIFICATION

Address (Include N,S,E,W; #; St., Ave., etc.) 6909 Longboat Dr S
Cross Streets (nearest /between) Cedar St
City / Town (within 3 miles) Town of Longboat Key In Current City Limits: X y o n o unknown
County Manatee Tax Parcel #(s) 77832.0000/4
Subdivision name Longbeach Block 10. Lot 13, 14
Ownership (Please check one): o private-profit X private-individual o city o county o Native American
o private-nonprofit o private-unspecified o state o federal o foreign o unknown
Name of Public Tract (e.g., park)
Route to (especially if no street address)

MAPPING

USGS 7.5' Map Name & Date Bradenton Beach, FL, 1964, PR 1987
Township 35S Range 16E Section 15 1/4 section: o NW o SW X SE o NE o Irregular-name:
Landgrant Thomas Mann UTM: Zone o16 X17 Easting 33464 0 Northing 303549070 0
Plat or other map (map's name, location) Longbeach/Revision of Longboat Beach, 1914 - Manatee Cnty Prop Appraiser

DESCRIPTION

Style*Frame Vernacular Exterior Plan* modified rectangular Number of Stories 1
Structural System(s) *wood frame
Foundation: Type(s) * piers Material(s) * Concrete
Exterior Fabric(s) *beveled cypress and board and batten siding
Roof: Type(s) * cross-hip Material(s) * metal
Roof secondary strucs. (dormers etc.) *
Chimney: No_1_ Material(s) *brick Location(s) *offset int W. slope
Windows (types, materials, etc.) *6/1 wood dhs ind andpaired; 1/1 alum sh, 5 light alum awn, paired
Main Entrance (stylistic details)
Porches: #open_1_ #closed_ #incised_1_ Location(s)N & W
Porch roof type(s) gable and hip
Exterior Ornament exposed rafter tails, milled screen ent door, rusticated blk planters, wood lattice foundation skirt
Interior Plan* Unknown
Condition (Please check one): oexcellent Xgood ofair odeteriorated oruinous
Surroundings (N=None, S=Some, M=Most, A=All/nearly all): N commercial A residential S institutional N undeveloped
Ancillary Features c.1956 E. single car garage
Archaeological Remains None Observed o Check if Archaeological Form completed
* Consult Guide to Historical Structure Forms for preferred descriptions (coded fields at the Site File).

DHR USE ONLY \$\$\$\$\$\$ OFFICIAL EVALUATIONS \$\$\$\$\$\$ DHR USE ONLY

NR DATE / / KEEPER-NR ELIGIBILITY oyes ono
Date / /
SHPO-NR ELIGIBILITY: oyes ono opotentially elig. oinsufficient Info Date / /
DELIST DATE / / LOCAL DESIGNATION: Date / /
Local office
National Register Criteria for Evaluation oa ob oc od (See National Register Bulletin 15, p. 2)

HISTORY

Construction date: Exactly _____(year) Approximately 1936 (year) Earlier than _____(year) Later than _____(year)
Architect (last name first): Kannenberg, Werner Builder (last name first): Local Carpenters
Moves: x yes no o unknown Dates 1956 Original address Whitney Beach, LBK
Alterations: X yes o no o unknown Dates c.1956 Nature* W.porch enc; partial window repl
Additions: x yes o no o unknown Dates c.1956,1999 Nature* S. room; planter wall
Original Use* (give date ranges) RESI
Intermediate Uses* (give date ranges) RESI
Present Use* (give date ranges) RESI
Ownership History (especially original owner, dates, profession, etc.)Whitney, Gordon (1934-1956); Byers (1956-?), Reed, Wallace (1981-87); Wellington, Duke (1987-96)
Johnson, April (1996-present)
* Consult Guide to Historical Structure Forms for preferred descriptions (coded fields at the Site File).

RESEARCH METHODS (Check all choices that apply; if needed write others at bottom)

- formal archaeological survey
- informal archaeological inspection
- Public Lands Survey (DEP)
- tax records/property deeds
- tax records only
- interior inspection
- other methods (specify) Longboat Key Historical Society Archives
- past surveys search at FMSF
- past sites search at FMSF
- FL Archives (Gray Building)
- FL Photo Archives (Gray Building)
- occupant/owner interview
- neighbor interview
- local library research
- non-local library research
- building permits
- demolition permits
- commercial permits
- occupation permits
- Sanborn maps
- subdivision maps
- plat maps
- local newspaper files

SURVEYOR'S EVALUATION OF SITE (Check one choice on each line)

Potentially eligible for local register? X yes: name register at right no o insufficient info Name of local register if eligible:LBK
Individually eligible for National Register? o yes x no o insufficient info
Potential contributor to Nat. Reg. district? o yes X no o insufficient info
Area(s) of Historical Significance (See National Register Bulletin 15, p. 8 for categories: e.g. "architecture", "ethnic heritage", "community planning & development", etc.)
Architecture and Community Development and Planning and Tourism
Explanation of Evaluation (required, whether positive or not; limit to three lines; attach longer statement, if needed, on separate sheet)
This 1930's Frame Vernacular former Whitney Beach cottage was relocated to its present site c1956. Although its significant for its association with Gordon Whitney, it does not appear to be eligible for N.R. listing.

DOCUMENTATION (Photos, Plans, etc.)

Bibliographic References (Use Continuation Sheet, give FMSF Manuscript # if relevant)
On site interview with April Johnson, present owner.
Whitney, Lora, Hail This Feisty Village, Rainbow Press, Torrington, CT, 1984, 1992, pp.8,9,40-43,45-48,53,54,57,63,64,67,69,72,75,76,78-80,96,97,112
Photographs (required) B&W print(s) at least 3 x 5, at least one main facade.
Location of negatives & negative numbers Longboat Key Historical Society 8/18,19

RECORDER

Name (last name first) / Address / Phone / Fax / Email / Affiliation Mikki Hartig, Historical & Architectural Research Services, 3708 Flores Avenue, Sarasota, FL 34239 / 941-955-6028

Remember: Use a Supplement for Site Forms or other continuation sheet for descriptions that do not fit in the spaces above.

- REQUIRED:
- (1) USGS 7.5' MAP WITH STRUCTURE PINPOINTED IN RED
 - (2) LARGE SCALE STREET OR PLAT MAP
 - (3) PHOTO OF MAIN FACADE, PREFER B&W, AT LEAST 3X5

PHOTOGRAPH

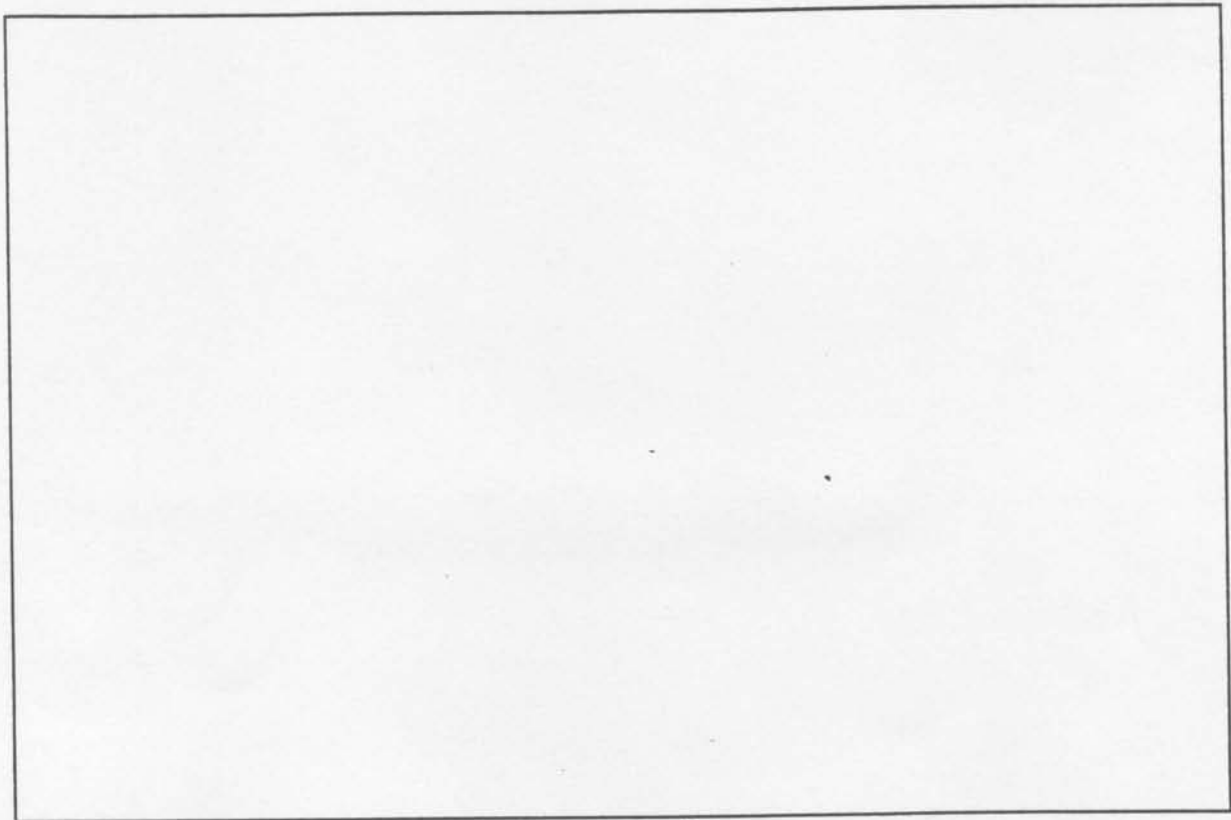

STREET OR PLAT MAP

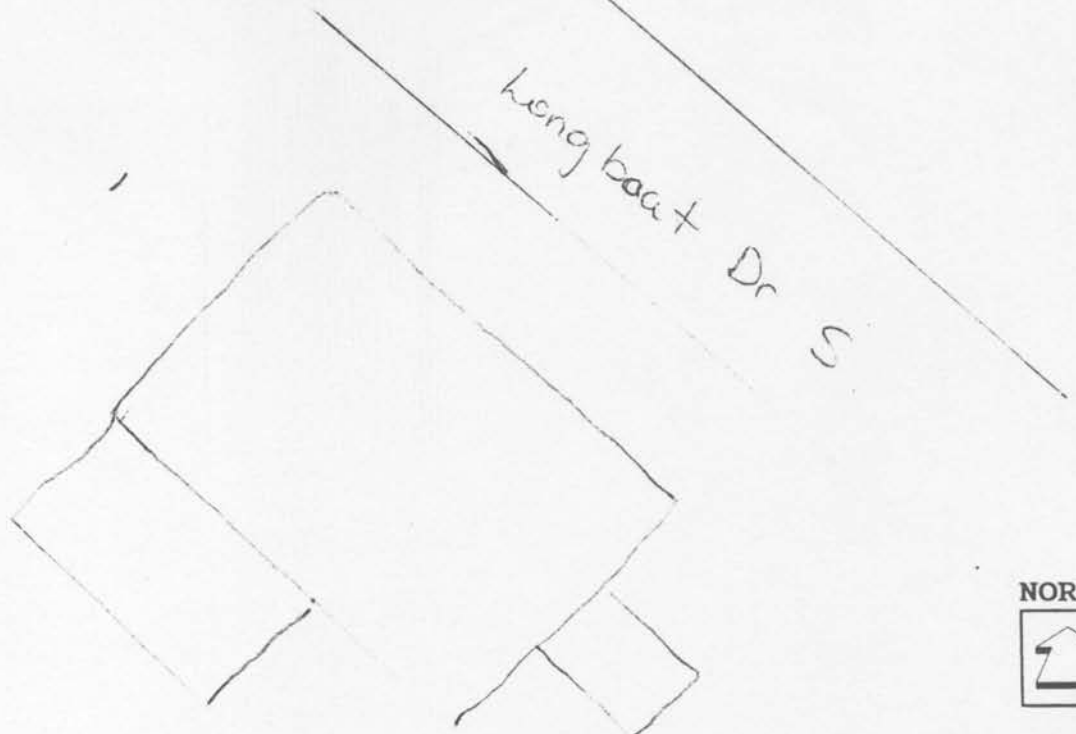

NOT TO SCALE

USGS MAP

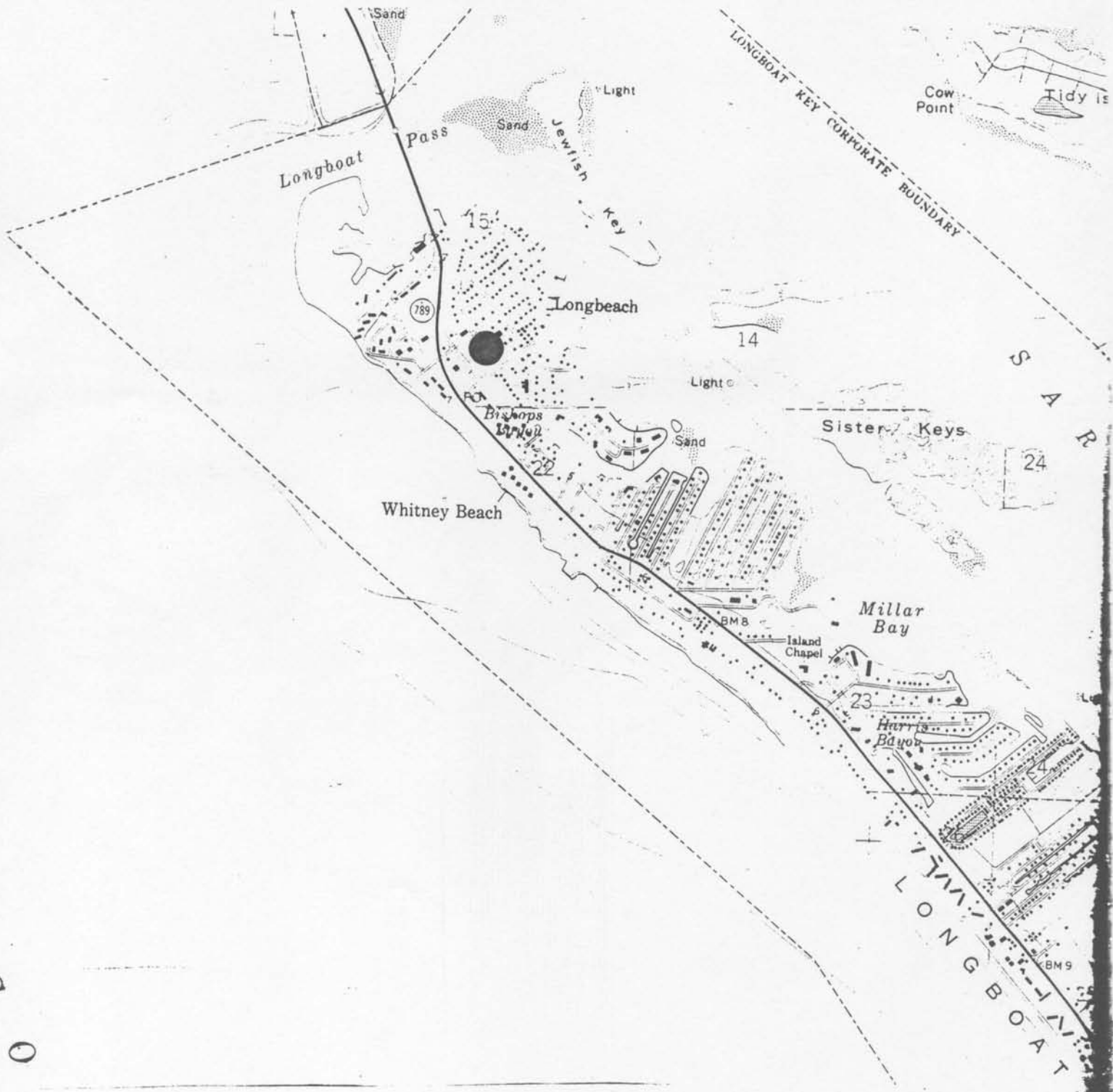

SCALE 1:24 000

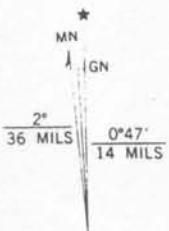
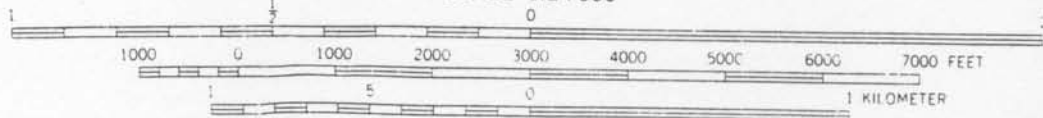

UTM GRID AND 1987 MAGNETIC NORTH DECLINATION AT CENTER OF SHEET

