

HISTORICAL STRUCTURE FORM

FLORIDA MASTER SITE FILE

Version 3.0 11/96

Site #8 MA-1048

Recorder \_\_\_\_\_

FieldDate 01/03/99

FormDate 05/31/99

- x Original
o Update (give site #)

SiteName(s)address if none).Whitney Beach Cottage #7.. Multiple Listing [DHR only]

Survey Longboat Key Survey #
National Register Category (Please check one: consult with Site File before using last 4): X building o structure o district o site o object

LOCATION & IDENTIFICATION

Address (Include N,S,E,W; #; St., Ave., etc.) 6881 Longboat Dr S
Cross Streets (nearest /between) Hibiscus Way
City / Town (within 3 miles) Town of Longboat Key In Current City Limits: X y o n o unknown
County Manatee Tax Parcel #(s) 77840.0000/7
Subdivision name Longbeach Block 10 Lot 15,16
Ownership (Please check one): o private-profit X private-individual o city o county o Native American
o private-nonprofit o private-unspecified o state o federal o foreign o unknown
Name of Public Tract (e.g., park)
Route to (especially if no street address)

MAPPING

USGS 7.5' Map Name & Date Bradenton Beach, FL, 1964, PR 1987
Township 35S Range 16E Section 15 1/4 section: o NW o SW X SE o NE o Irregular-name:
Landgrant Thomas Mann UTM: Zone o16 X17 Easting 33464 0 Northing 303549070 0
Plat or other map (map's name, location) Longbeach/Revision of Longboat Beach, 1914 - Manatee Cnty Prop Appraiser

DESCRIPTION

Style\*Frame Vernacular Exterior Plan\* modified rectangular Number of Stories 1
Structural System(s) \*wood frame
Foundation: Type(s) \* Continuous, piers Material(s) \* Concrete Block, Conc.
Exterior Fabric(s) \*board and batten and beveled pecky cypress siding
Roof: Type(s) \* hip and flat Material(s) \* asphalt shingle
Roof secondary strucs. (dormers etc.) \*
Chimney: No. 1 Material(s) \*brick Location(s) \*S int slope
Windows (types, materials, etc.) \*6/1 wood DHS, ind and paired; SL alum awning; 2 & 4 light alum awning, ind and paired
Main Entrance (stylistic details)
Porches: #open 1 #closed #incised Location(s) N
Porch roof type(s)
Exterior Ornament exposed rafter tails
Interior Plan\* Unknown
Condition (Please check one): oexcellent Xgood ofair odeteriorated oruinous
Surroundings (N=None, S=Some, M=Most, A=All/nearly all): N commercial A residential S institutional N undeveloped
Ancillary Features c.1956 N. wood frame single car garage
Archaeological Remains None Observed o Check if Archaeological Form completed
\* Consult Guide to Historical Structure Forms for preferred descriptions (coded fields at the Site File).

DHR USE ONLY OFFICIAL EVALUATIONS DHR USE ONLY

Form with fields for NR DATE, DELIST DATE, LOCAL DESIGNATION, and LOCAL OFFICE.

National Register Criteria for Evaluation oa ob oc od (See National Register Bulletin 15, p. 2)

Consult *Guide to Historical Structure Forms* for detailed instructions.

**HISTORY**

Construction date: Exactly \_\_\_\_\_(year) Approximately 1935 (year) Earlier than \_\_\_\_\_(year) Later than \_\_\_\_\_(year)

Architect (last name first): Huzak, Ralph Builder (last name first): Local Carpenters

Moves:  yes  no  unknown . . . . Dates 1956 Original address Whitney Beach, LBK

Alterations:  yes  no  unknown Datesc.1960 Nature\* N. reovoal of open front ent porch, partial window rep

Additions:  yes  no  unknown Datesc.1956,1960 Nature\* N & W rooms, detached garage

Original Use\* (give date ranges) RESI

Intermediate Uses\* (give date ranges) RESI

Present Use\* (give date ranges) RESI

Ownership History (especially original owner, dates, profession, etc.) Whitney, Gordon (1934-57), Albinson, Grace (c1960-73)

Brush, Frances (1973-present)

\* Consult *Guide to Historical Structure Forms* for preferred descriptions (coded fields at the Site File).

**RESEARCH METHODS (Check all choices that apply; if needed write others at bottom)**

- formal archaeological survey
- informal archaeological inspection
- Public Lands Survey (DEP)
- tax records/property deeds
- tax records only
- interior inspection
- other methods (specify) Longboat Key Historical Society Archives
- past surveys search at FMSF
- past sites search at FMSF
- FL Archives (Gray Building)
- FL Photo Archives (Gray Building)
- occupant/owner interview
- neighbor interview
- local library research
- non-local library research
- building permits
- demolition permits
- commercial permits
- occupation permits
- Sanborn maps
- subdivision maps
- plat maps
- local newspaper files

**SURVEYOR'S EVALUATION OF SITE (Check one choice on each line)**

Potentially eligible for local register?  yes: name register at right  no  insufficient info Name of local register if eligible:

Individually eligible for National Register?  yes  no  insufficient info

Potential contributor to Nat. Reg. district?  yes  no  insufficient info

Area(s) of Historical Significance (See *National Register Bulletin 15*, p. 8 for categories: e.g. "architecture", "ethnic heritage", "community planning & development", etc.)

Architecture and Community Planning and Development and Tourism

Explanation of Evaluation (required, whether positive or not; limit to three lines; attach longer statement, if needed, on separate sheet)

**This former Whitney Beach cottage was moved to this site in 1956. It has been modified with c.1960 N & W room additions and partial window rep. Although of note for its association with Gordon Whitney, it does not appear to be N.R. eligible.**

**DOCUMENTATION (Photos, Plans, etc.)**

Bibliographic References (Use Continuation Sheet, give FMSF Manuscript # if relevant)

Frances Brush, on site interview, 7/17/99

Whitney, Lora, Hail This Feisty Village, Rainbow Press, Torrington, CT, 1984, 1992, pp.8,40-43,45-48,53,54,63,64,67,69,75,76,78-80,96,97,112

Photographs (required) B&W print(s) at least 3 x 5, at least one main facade.

Location of negatives & negative numbers Longboat Key Historical Society 8/20,21

**RECORDER**

Name (last name first) / Address / Phone / Fax / Email / Affiliation Mikki Hartig, Historical & Architectural Research Services, 3708 Flores Avenue, Sarasota, FL 34239 / 941-955-6028

Remember: Use a *Supplement for Site Forms* or other continuation sheet for descriptions that do not fit in the spaces above.

- REQUIRED:
- (1) USGS 7.5' MAP WITH STRUCTURE PINPOINTED IN RED
  - (2) LARGE SCALE STREET OR PLAT MAP
  - (3) PHOTO OF MAIN FACADE, PREFER B&W, AT LEAST 3X5

USGS MAP



SCALE 1:24 000

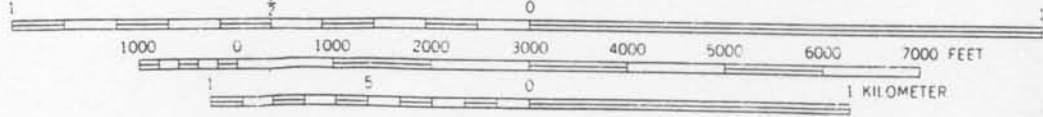

PHOTOGRAPH

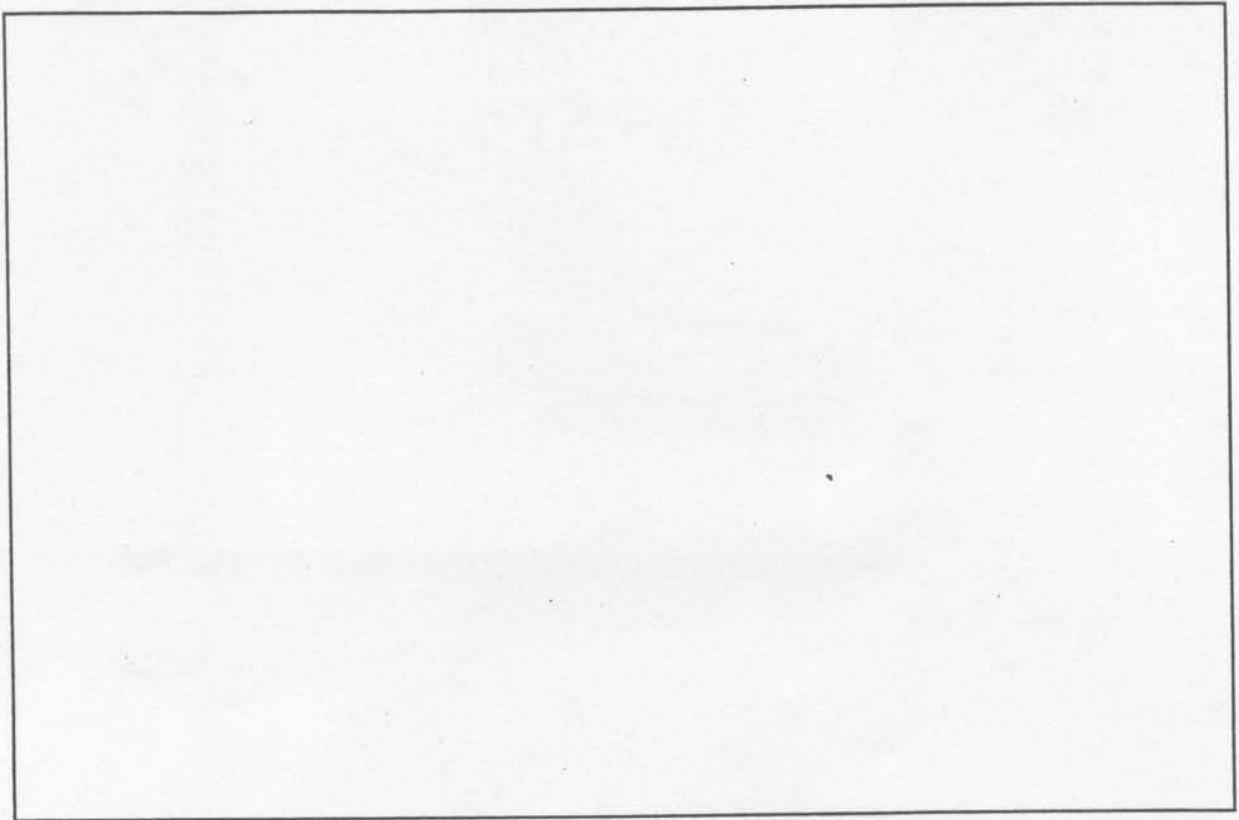

STREET OR PLAT MAP

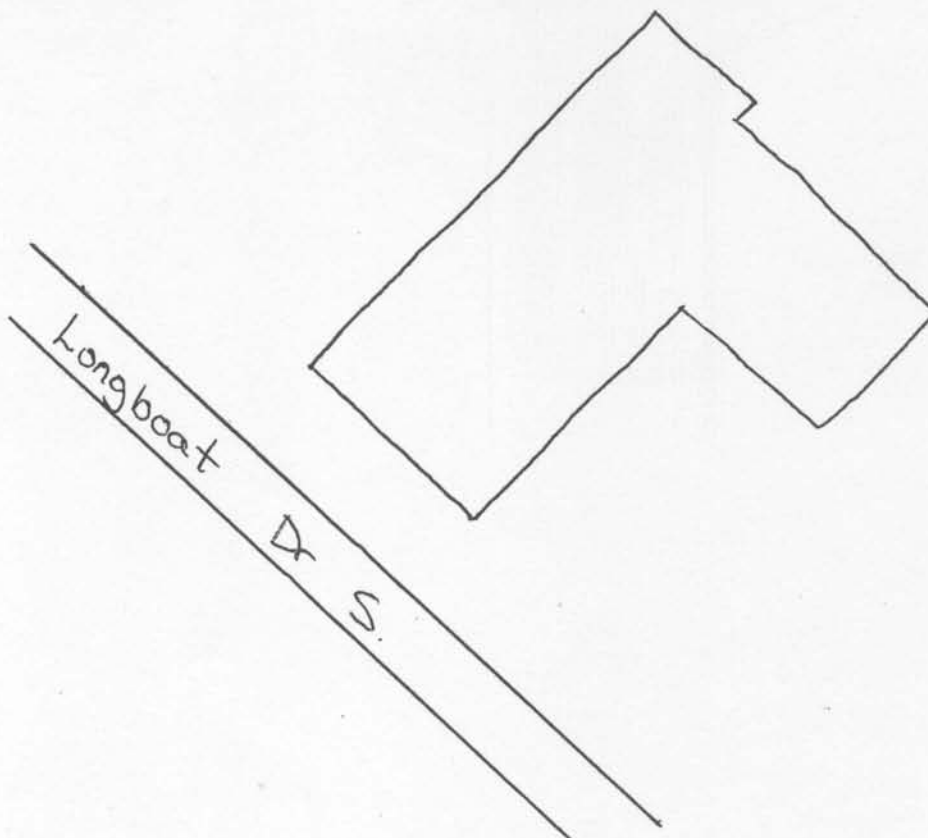

NORTH



NOT TO SCALE





