

HISTORICAL STRUCTURE FORM

FLORIDA MASTER SITE FILE

Version 3.0 11/96

Site #8 MA-1072

Recorder

FieldDate 01/03/99

FormDate 05/31/99

- x Original
o Update (give site #)

SiteName(s)address if none).Whitney Beach Cottage #6. Multiple Listing [DHR only]

Survey Longboat Key Survey #
National Register Category (Please check one: consult with Site File before using last 4): X building o structure o district o site o object

LOCATION & IDENTIFICATION

Address (Include N,S,E,W; #; St., Ave., etc.) 6871 Longboat Drive S.
Cross Streets (nearest /between)
City / Town (within 3 miles) Town of Longboat Key In Current City Limits: X y o n o unknown
County Manatee Tax Parcel #(s) 77837.0000/3
Subdivision name Longbeach Block Lot 16, 17 & 18
Ownership (Please check one): o private-profit X private-individual o city o county o Native American
o private-nonprofit o private-unspecified o state o federal o foreign o unknown
Name of Public Tract (e.g., park)
Route to (especially if no street address)

MAPPING

USGS 7.5' Map Name & Date Bradenton Beach, FL, 1964, PR 1987
Township 35S Range 16E Section 15 1/4 section: o NW o SW X SE o NE o Irregular-name:
Landgrant Thomas Mann UTM: Zone o16 X17 Easting 33464 0 Northing 303549070 0
Plat or other map (map's name, location) Longbeach/Revision of Longboat Beach, 1914 - Manatee Cnty Prop Appraiser

DESCRIPTION

Style* Frame Vernacular Exterior Plan* irregular Number of Stories1 & 2
Structural System(s) *wood frame
Foundation: Type(s) * Continuous and pilings Material(s) * Concrete Block and wood
Exterior Fabric(s) *board and batten and beveled cyoress siding
Roof: Type(s) * Gable Material(s) * asphalt shingle
Roof secondary strucs. (dormers etc.) *
Chimney: No. 1 Material(s) *brick Location(s) *S int slope
Windows (types, materials, etc.) *6/1 wood dhs, ind, paired; 1/1 alum, ind; 5 light alum awn, ind; 3 light alum awn,
paired; jalousie, ind, paired
Main Entrance (stylistic details) contemp stairs and landing
Porches: #open 2 #closed #incised Location(s) E & W
Porch roof type(s)
Exterior Ornament exposed rafter tails
Interior Plan* Unknown
Condition (Please check one): oexcellent ogood ofair odeteriorated oruinous
Surroundings (N=None, S=Some, M=Most, A=All/nearly all): N commercial A residential S institutional N undeveloped
Ancillary Features
Archaeological Remains None Observed o Check if Archaeological Form completed
* Consult Guide to Historical Structure Forms for preferred descriptions (coded fields at the Site File).

DHR USE ONLY OFFICIAL EVALUATIONS DHR USE ONLY

Form with fields for NR DATE, DELIST DATE, LOCAL DESIGNATION, and National Register Criteria for Evaluation.

HISTORY

Construction date: Exactly _____ (year) Approximately 1935 (year) Earlier than _____ (year) Later than _____ (year)
Architect (last name first): Huzak, Ralph Builder (last name first): Local Carpenters
Moves: yes no unknown Dates 1956 Original address Whitney Beach, LBK
Alterations: yes no unknown Dates c. 1956, 1970 Nature* partial window replacement
Additions: yes no unknown Dates c. 1956, 1986 Nature* E. single car garage w/ 2nd floor bedroom, wood boat dock, partial 2nd floor elevation above floodplain
Original Use* (give date ranges) RESI
Intermediate Uses* (give date ranges) RESI

Present Use* (give date ranges) RESI
Ownership History (especially original owner, dates, profession, etc.) Whitney, Gordon (1935-1956), Geeslin, Mary (1979-present)

* Consult *Guide to Historical Structure Forms* for preferred descriptions (coded fields at the Site File).

RESEARCH METHODS (Check all choices that apply; if needed write others at bottom)

- formal archaeological survey
- informal archaeological inspection
- Public Lands Survey (DEP)
- tax records/property deeds
- tax records only
- interior inspection
- other methods (specify) Longboat Key Historical Society Archives
- past surveys search at FMSF
- past sites search at FMSF
- FL Archives (Gray Building)
- FL Photo Archives (Gray Building)
- occupant/owner interview
- neighbor interview
- local library research
- non-local library research
- building permits
- demolition permits
- commercial permits
- occupation permits
- Sanborn maps
- subdivision maps
- plat maps
- local newspaper files

SURVEYOR'S EVALUATION OF SITE (Check one choice on each line)

Potentially eligible for local register? yes: name register at right no insufficient info Name of local register if eligible:
Individually eligible for National Register? yes no insufficient info
Potential contributor to Nat. Reg. district? yes no insufficient info
Area(s) of Historical Significance (See *National Register Bulletin 15*, p. 8 for categories: e.g. "architecture", "ethnic heritage", "community planning & development", etc.) Architecture and Community Planning and Development and Tourism
Explanation of Evaluation (required, whether positive or not; limit to three lines; attach longer statement, if needed, on separate sheet)
This considerably modified frame Whitney Beach cottage includes several c.1986 additions that were built at the time the house was elevated above floodplain. These additions appear to exclude it from N.R. eligibility.

DOCUMENTATION (Photos, Plans, etc.)

Bibliographic References (Use Continuation Sheet, give FMSF Manuscript # if relevant)
Whitney, Lora, *Hail This Feisty Village*, Rainbow Press, Torrington, CT, 1984, 1992, pp.8,40-43,45-48,53,54,63,64,67,69,75,76,78-80,96,97,112
Photographs (required) B&W print(s) at least 3 x 5, at least one main facade.
Location of negatives & negative numbers Longboat Key Historical Society 8/10,11

RECORDER

Name (last name first) / Address / Phone / Fax / Email / Affiliation Mikki Hartig, Historical & Architectural Research Services, 3708 Flores Avenue, Sarasota, FL 34239 / 941-955-6028

Remember: Use a *Supplement for Site Forms* or other continuation sheet for descriptions that do not fit in the spaces above.

- REQUIRED:
- (1) USGS 7.5' MAP WITH STRUCTURE PINPOINTED IN RED
 - (2) LARGE SCALE STREET OR PLAT MAP
 - (3) PHOTO OF MAIN FACADE, PREFER B&W, AT LEAST 3X5

PHOTOGRAPH

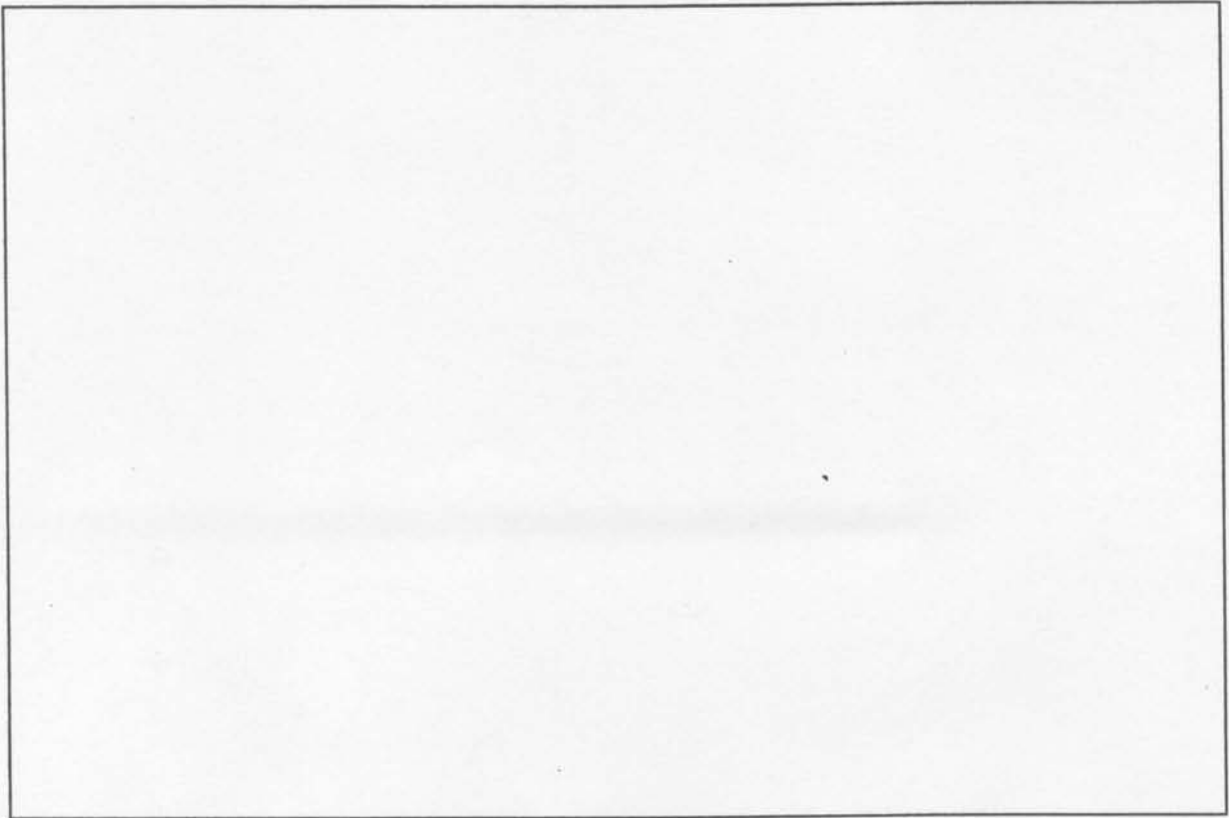

STREET OR PLAT MAP

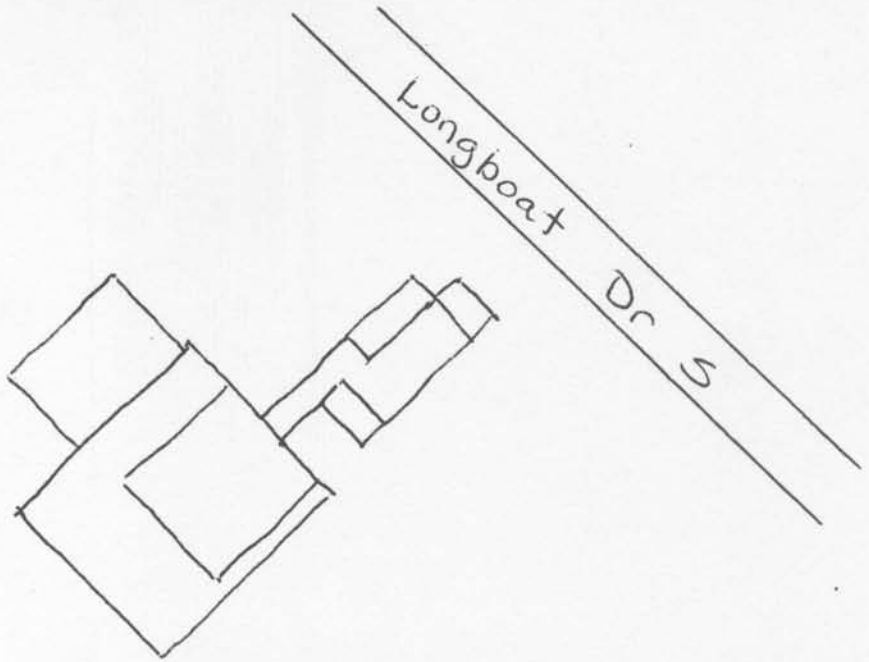

NOT TO SCALE

USGS MAP

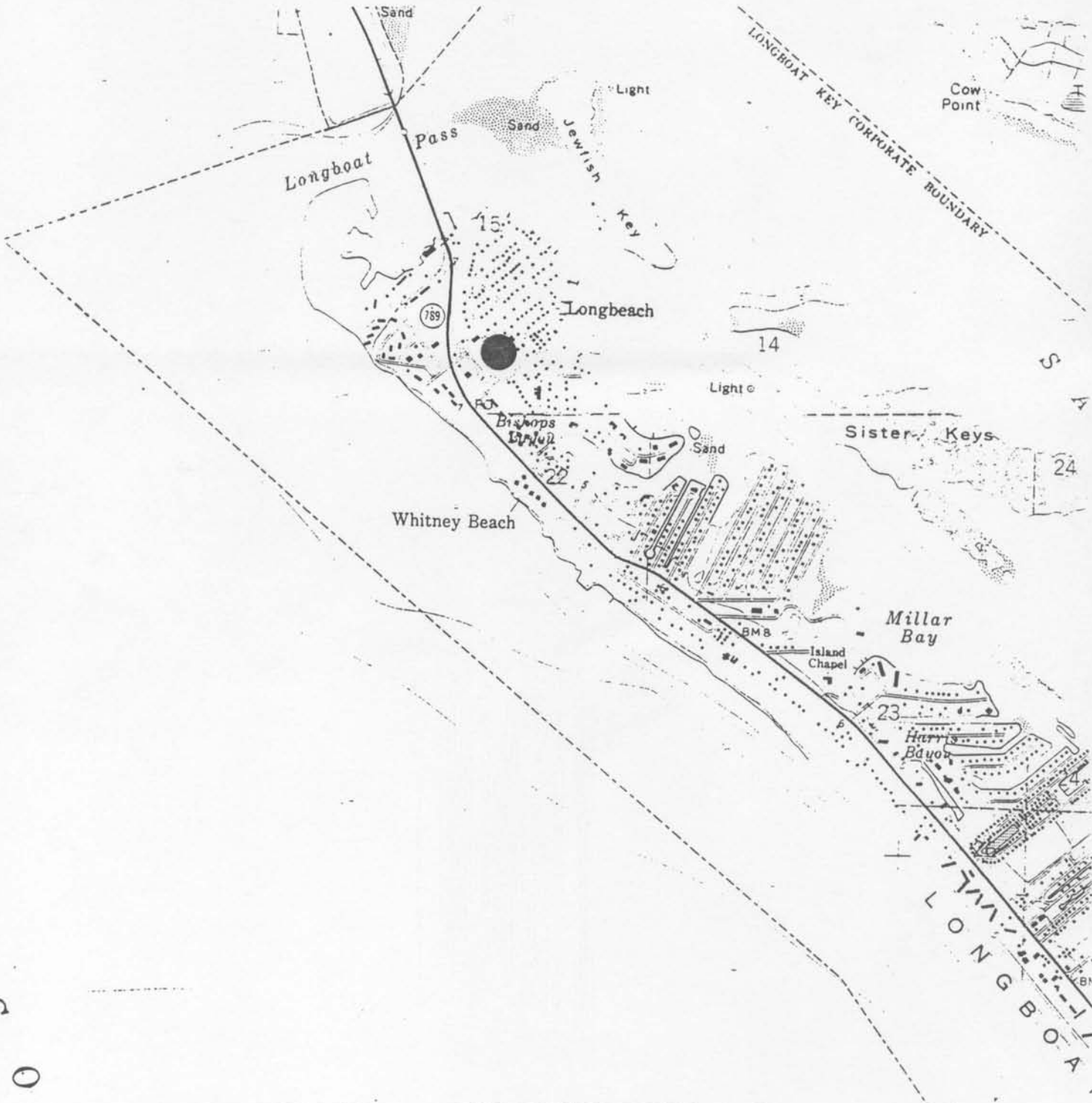

SCALE 1:24 000

